

TPRO 17

CE EN60974-7



| CODE | ↔ | | ↕ | ⚡ |
|-----------|-----|-------|-----------|-------------|
| HF2407-00 | 4 m | 12.5' | dual | TSK 50-1/4G |
| HF2807-00 | 8 m | 25' | dual | |
| HG2407-00 | 4 m | 12.5' | dual flex | |
| HG2807-00 | 8 m | 25' | dual flex | |

| TECHNICAL DATA | | |
|----------------|-------------------|---------------|
| | TPRO 17 | |
| | 0,55 kg | 1.22 lb |
| | 113 | |
| | Argon | |
| | 0,5 ÷ 2,4 mm | .020" ÷ 3/32" |
| | 140A DC - 125A AC | |

| CODE | | | |
|------|--------|--|--------------------------------|
| 4 | TQ0002 | | insulator 10 |
| 5 | TF0017 | | tig 17 torch head 1 |
| 6 | TF0022 | | tig 17 flex torch head 1 |
| 7 | BW0066 | | back cap 117 mm 10 |
| 7 | EA0130 | | O-ring Ø 9x2 mm 10 |
| 8 | TT0183 | | kit Tpro Dual 1 |
| 9 | TT0184 | | kit Tpro Multi 1 |
| 10 | BW0303 | | reduction 1 |
| 10 | BW0310 | | cable joint 1 |
| 10 | EA0329 | | screw 50 |
| 10 | TP0139 | | Tpro handle 1 |
| 11 | TH1212 | | cable assembly - 4 m / 12.5' 1 |
| 11 | TH1213 | | cable assembly - 8 m / 25' 1 |
| 12 | TH1332 | | power cable - 4 m / 12.5' 1 |
| 12 | TH1333 | | power cable - 8 m / 25' 1 |
| 15 | CX0077 | | TSK 50 - 1/4 G plug 1 |

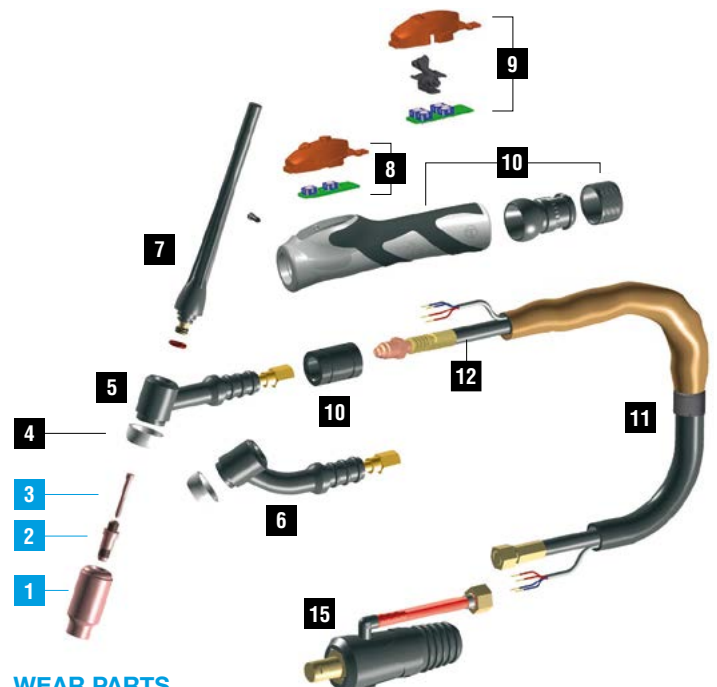

WEAR PARTS NOT INCLUDED
 Starter kits page 360
 Wear parts page 362

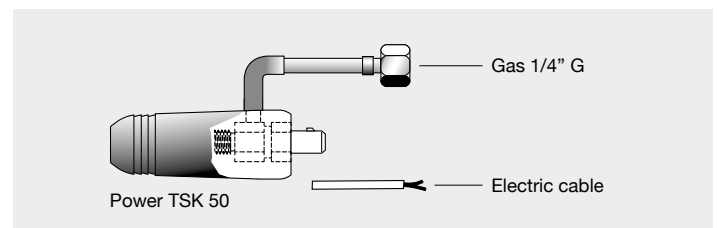

SERIES 17 - 18 - 26 - SUPER 18 WEAR PARTS

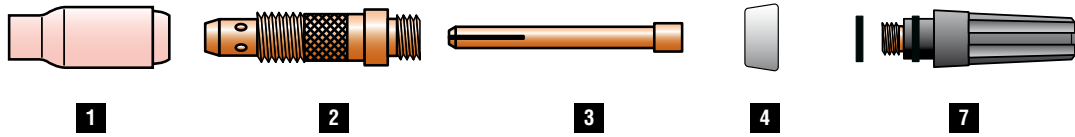

STANDARD

| | CODE | | Gr | Ø | | REF | |
|---|-----------|--|----|---------------|-------|--------|----|
| 1 | TC0002 | | 4 | 6,4 mm 1/4" | 47 mm | 10N50 | 10 |
| 1 | TC0003 | | 5 | 8 mm 5/16" | 47 mm | 10N49 | 10 |
| 1 | TC0004 | | 6 | 9,8 mm 3/8" | 47 mm | 10N48 | 10 |
| 1 | TC0005 | | 7 | 11,2 mm 7/16" | 47 mm | 10N47 | 10 |
| 1 | TC0006 | | 8 | 12,7 mm 1/2" | 47 mm | 10N46 | 10 |
| 1 | TC0007 | | 10 | 15,7 mm 5/8" | 47 mm | 10N45 | 10 |
| 1 | TC0008 | | 12 | 19 mm 3/4" | 47 mm | 10N44 | 10 |
| 1 | TC0091 | | 5 | 8 mm 5/16" | 76 mm | 10N49L | 10 |
| 1 | TC0092 | | 6 | 9,5 mm 3/8" | 76 mm | 10N48L | 10 |
| 1 | TC0093 | | 7 | 11 mm | 76 mm | 10N47L | 10 |
| 2 | TE0001-05 | | | 0,5 mm .020" | 47 mm | 10N29 | 10 |
| 2 | TE0001-10 | | | 1,0 mm .040" | 47 mm | 10N30 | 10 |
| 2 | TE0001-16 | | | 1,6 mm 1/16" | 47 mm | 10N31 | 10 |
| 2 | TE0001-20 | | | 2,0 mm 5/64" | 47 mm | - | 10 |
| 2 | TE0001-24 | | | 2,4 mm 3/32" | 47 mm | 10N32 | 10 |
| 2 | TE0001-32 | | | 3,2 mm 1/8" | 47 mm | 10N28 | 10 |
| 2 | TE0001-40 | | | 4,0 mm 5/32" | 47 mm | 406488 | 10 |
| 2 | TE0001-48 | | | 4,8 mm 3/16" | 47 mm | 30126 | 10 |

| | CODE | | Gr | Ø | | REF | |
|---|-----------|--|----|--------------|---------|-------|----|
| 3 | TD0001-05 | | | 0,5 mm .020" | 50 mm | 10N21 | 10 |
| 3 | TD0001-10 | | | 1,0 mm .040" | 50 mm | 10N22 | 10 |
| 3 | TD0001-16 | | | 1,6 mm 1/16" | 50 mm | 10N23 | 10 |
| 3 | TD0001-20 | | | 2,0 mm 5/64" | 50 mm | - | 10 |
| 3 | TD0001-24 | | | 2,4 mm 3/32" | 50 mm | 10N24 | 10 |
| 3 | TD0001-32 | | | 3,2 mm 1/8" | 50 mm | 10N25 | 10 |
| 3 | TD0001-40 | | | 4,0 mm 5/32" | 50 mm | 54N20 | 10 |
| 3 | TD0001-48 | | | 4,8 mm 3/16" | 50 mm | 30028 | 10 |
| 4 | TQ0002 | | | | | 18CG | 10 |
| 4 | TQ0008 * | | | | | - | 10 |
| 7 | BW0056 | | | | 58 mm | 57Y03 | 10 |
| 7 | BW0066 | | | | 117 mm | 57Y02 | 10 |
| 7 | BW0067 | | | | 22,5 mm | 57Y04 | 10 |
| 7 | EA0130 | | | | | | 10 |

* ONLY FOR 18 HC

GAS LENS

| | CODE | | Gr | Ø | | REF | |
|---|-----------|-----------|----|---------------|---------|--------|----|
| 1 | TC0031 | | 4 | 6,4 mm 1/4" | 42 mm | 54N18 | 10 |
| 1 | TC0032 | | 5 | 8 mm 5/16" | 42 mm | 54N17 | 10 |
| 1 | TC0033 | | 6 | 9,8 mm 3/8" | 42 mm | 54N16 | 10 |
| 1 | TC0034 | | 7 | 11,2 mm 7/16" | 42 mm | 54N15 | 10 |
| 1 | TC0035 | | 8 | 12,7 mm 1/2" | 42 mm | 54N14 | 10 |
| 1 | TC0036 | | 11 | 19 mm 3/4" | 42 mm | 53N87 | 10 |
| 1 | TC0037 | | | 17,2 mm | 28,6 mm | 54N19 | 10 |
| 1 | TC0086 | | 5 | 8 mm 5/16" | 76 mm | 54N17L | 10 |
| 1 | TC0087 | | 6 | 9,5 mm 3/8" | 76 mm | 54N16L | 10 |
| 1 | TC0088 | | 7 | 11 mm | 76 mm | 54N15L | 10 |
| 2 | TE0006-05 | | | 0,5 mm .020" | 50 mm | 45V29 | 10 |
| 2 | TE0006-10 | | | 1,0 mm .040" | 50 mm | 45V24 | 10 |
| 2 | TE0006-16 | | | 1,6 mm 1/16" | 50 mm | 45V25 | 10 |
| 2 | TE0006-20 | | | 2,0 mm 5/64" | 50 mm | - | 10 |
| 2 | TE0006-24 | Cu + CuZn | | 2,4 mm 3/32" | 50 mm | 45V26 | 10 |
| 2 | TE0006-32 | | | 3,2 mm 1/8" | 50 mm | 45V27 | 10 |
| 2 | TE0006-40 | | | 4,0 mm 5/32" | 50 mm | 45V28 | 10 |
| 3 | TD0022-10 | | | 1,0 mm .040" | 52 mm | - | 10 |
| 3 | TD0022-16 | | | 1,6 mm 1/16" | 52 mm | - | 10 |
| 3 | TD0022-24 | | | 2,4 mm 3/32" | 52 mm | - | 10 |
| 3 | TD0022-32 | | | 3,2 mm 1/8" | 52 mm | - | 10 |
| 3 | TD0022-40 | | | 4,0 mm 5/32" | 52 mm | - | 10 |
| 4 | TQ0003 | | | | | 54N01 | 10 |
| 7 | BW0056 | | | | 58 mm | 57Y03 | 10 |
| 7 | BW0066 | | | | 117 mm | 57Y02 | 10 |
| 7 | BW0067 | | | | 22,5 mm | 57Y04 | 10 |
| 7 | EA0130 | | | | | | 10 |

GAS LENS XL (JUMBO)

| | CODE | | Gr | Ø | | REF | |
|---|-----------|--|----|--------------|---------|--------|----|
| 1 | TC0118 | | 8 | 12,7 mm 1/2" | 48 mm | 57N74 | 10 |
| 1 | TC0119 | | 10 | 15,7 mm 5/8" | 48 mm | 53N88 | 10 |
| 1 | TC0120 | | 12 | 19,5 mm 3/4" | 48 mm | 53N87 | 10 |
| 2 | TE0009-16 | | | 1,6 mm 1/16" | 51 mm | 45V16 | 2 |
| 2 | TE0009-24 | | | 2,4 mm 3/32" | 51 mm | 45V64 | 2 |
| 2 | TE0009-32 | | | 3,2 mm 1/8" | 51 mm | 995795 | 2 |
| 2 | TE0009-40 | | | 4,0 mm 5/32" | 51 mm | 45V63 | 2 |
| 3 | TD0001-05 | | | 0,5 mm .020" | 50 mm | 10N21 | 10 |
| 3 | TD0001-10 | | | 1,0 mm .040" | 50 mm | 10N22 | 10 |
| 3 | TD0001-16 | | | 1,6 mm 1/16" | 50 mm | 10N23 | 10 |
| 3 | TD0001-20 | | | 2,0 mm 5/64" | 50 mm | - | 10 |
| 3 | TD0001-24 | | | 2,4 mm 3/32" | 50 mm | 10N24 | 10 |
| 3 | TD0001-32 | | | 3,2 mm 1/8" | 50 mm | 10N25 | 10 |
| 3 | TD0001-40 | | | 4,0 mm 5/32" | 50 mm | 54N20 | 10 |
| 3 | TD0001-48 | | | 4,8 mm 3/16" | 50 mm | 30028 | 10 |
| 4 | TQ0027 | | | | | 54N63 | 10 |
| 7 | BW0056 | | | | 58 mm | 57Y03 | 10 |
| 7 | BW0066 | | | | 117 mm | 57Y02 | 10 |
| 7 | BW0067 | | | | 22,5 mm | 57Y04 | 10 |
| 7 | EA0130 | | | | | | 10 |

Gas protection flow is usually guttered by a STANDARD ceramic nozzle (picture 1). Such flow is affected by turbulences of head torch which are caused by the inlet pressure. In order to assure a uniform gas distribution, above all in stainless steel, titanium and aluminium alloys welding, we suggest the use of GAS LENS spare parts. The electrode holder equipped with a gas lens net, uniform the flow (picture 2) and aid to save the protection gas. Where permitted by external dimensions, it is recommended the JUMBO version which increases the protected surface with advantage for welding quality (picture 3).

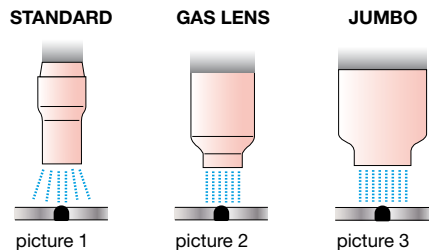

SERIES 17 - 18 - 26 - SUPER 18 STUBBY WEAR PARTS

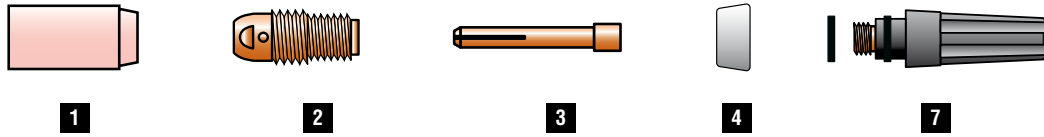

STUBBY

| | CODE | | Gr | Ø | | REF | |
|---|-----------|--|----|---------------|---------|--------|----|
| 1 | TC0012 | | 4 | 6,4 mm 1/4" | 30 mm | 13N08 | 10 |
| 1 | TC0013 | | 5 | 8 mm 5/16" | 30 mm | 13N09 | 10 |
| 1 | TC0014 | | 6 | 9,8 mm 3/8" | 30 mm | 13N10 | 10 |
| 1 | TC0015 | | 7 | 11,2 mm 7/16" | 30 mm | 13N11 | 10 |
| 1 | TC0016 | | 8 | 12,7 mm 1/2" | 30 mm | 13N12 | 10 |
| 1 | TC0017 | | 10 | 15,7 mm 5/8" | 30 mm | 13N13 | 10 |
| 1 | TC0096 | | 4 | 6,5 mm 1/4" | 48 mm | 796F71 | 10 |
| 1 | TC0097 | | 5 | 8 mm 5/16" | 48 mm | 796F72 | 10 |
| 1 | TC0098 | | 6 | 9,5 mm 3/8" | 48 mm | 796F73 | 10 |
| 1 | TC0101 | | 4 | 6,5 mm 1/4" | 63 mm | 796F75 | 10 |
| 1 | TC0102 | | 5 | 8 mm 5/16" | 63 mm | 796F76 | 10 |
| 1 | TC0103 | | 4 | 6,5 mm 1/4" | 89 mm | 796F79 | 10 |
| 2 | TE0002-00 | | | 1,0 mm .040" | 24,5 mm | 17CB20 | 10 |
| 3 | TD0002-10 | | | 1,0 mm .040" | 29 mm | 10N22S | 10 |
| 3 | TD0002-16 | | | 1,6 mm 1/16" | 29 mm | 10N23S | 10 |
| 3 | TD0002-20 | | | 2,0 mm | 29 mm | | 10 |
| 3 | TD0002-24 | | | 2,4 mm 3/32" | 29 mm | 10N24S | 10 |
| 3 | TD0002-32 | | | 3,2 mm 1/8" | 29 mm | 10N25S | 10 |
| 4 | TQ0002 | | | | | 18CG | 10 |
| 4 | TQ0008 * | | | | | - | 10 |
| 7 | BW0056 | | | | 58 mm | 57Y03 | 10 |
| 7 | BW0066 | | | | 117 mm | 57Y02 | 10 |
| 7 | BW0067 | | | | 22,5 mm | 57Y04 | 10 |
| 7 | EA0130 | | | | | | 10 |

* ONLY FOR 18 HC

STUBBY GAS LENS

| | CODE | | Gr | Ø | | REF | |
|---|-----------|--|-------------|---------------|---------|--------|----|
| 1 | TC0041 | | 4 | 6,4 mm 1/4" | 25,5 mm | 53N58 | 10 |
| 1 | TC0042 | | 5 | 8 mm 5/16" | 25,5 mm | 53N59 | 10 |
| 1 | TC0043 | | 6 | 9,8 mm 3/8" | 25,5 mm | 53N60 | 10 |
| 1 | TC0044 | | 7 | 11,2 mm 7/16" | 25,5 mm | 53N61 | 10 |
| 1 | TC0045 | | 8 | 12,7 mm 1/2" | 25,5 mm | 53N61S | 10 |
| 2 | TE0095-16 | | | 1,6 mm 1/16" | 29 mm | - | 10 |
| 2 | TE0095-20 | | | 2,0 mm 5/64" | 29 mm | - | 10 |
| 2 | TE0095-24 | | | 2,4 mm 3/32" | 29 mm | - | 10 |
| 2 | TE0095-32 | | 3,2 mm 1/8" | 29 mm | - | 10 | |
| 3 | TD0095-16 | | | 1,6 mm 1/16" | 30,7 mm | - | 10 |
| 3 | TD0095-20 | | | 2,0 mm 5/64" | 30,7 mm | - | 10 |
| 3 | TD0095-24 | | | 2,4 mm 3/32" | 30,7 mm | - | 10 |
| 3 | TD0095-32 | | | 3,2 mm 1/8" | 30,7 mm | - | 10 |
| 4 | TQ0095 | | | | | 18CG20 | 10 |
| 4 | TQ0096 * | | | | | | 10 |
| 7 | BW0056 | | | | 58 mm | 57Y03 | 10 |
| 7 | BW0066 | | | | 117 mm | 57Y02 | 10 |
| 7 | BW0067 | | | | 22,5 mm | 57Y04 | 10 |
| 7 | EA0130 | | | | | | 10 |

* ONLY FOR 18 HC

STUBBY GAS LENS (Cu)

| | CODE | | Gr | Ø | | REF | |
|---|-----------|--|-------------|---------------|---------|--------|----|
| 1 | TC0041 | | 4 | 6,4 mm 1/4" | 25,5 mm | 53N58 | 10 |
| 1 | TC0042 | | 5 | 8 mm 5/16" | 25,5 mm | 53N59 | 10 |
| 1 | TC0043 | | 6 | 9,8 mm 3/8" | 25,5 mm | 53N60 | 10 |
| 1 | TC0044 | | 7 | 11,2 mm 7/16" | 25,5 mm | 53N61 | 10 |
| 1 | TC0045 | | 8 | 12,7 mm 1/2" | 25,5 mm | 53N61S | 10 |
| 2 | TE0096-16 | | | 1,6 mm 1/16" | 30,6 mm | - | 10 |
| 2 | TE0096-20 | | | 2,0 mm 5/64" | 30,6 mm | - | 10 |
| 2 | TE0096-24 | | | 2,4 mm 3/32" | 30,6 mm | - | 10 |
| 2 | TE0096-32 | | 3,2 mm 1/8" | 30,6 mm | - | 10 | |
| 3 | TD0096-16 | | | 1,6 mm 1/16" | 33 mm | - | 10 |
| 3 | TD0096-20 | | | 2,0 mm 5/64" | 33 mm | - | 10 |
| 3 | TD0096-24 | | | 2,4 mm 3/32" | 33 mm | - | 10 |
| 3 | TD0096-32 | | | 3,2 mm 1/8" | 33 mm | - | 10 |
| 4 | TQ0095 | | | | | 18CG20 | 10 |
| 4 | TQ0096 * | | | | | | 10 |
| 7 | BW0056 | | | | 58 mm | 57Y03 | 10 |
| 7 | BW0066 | | | | 117 mm | 57Y02 | 10 |
| 7 | BW0067 | | | | 22,5 mm | 57Y04 | 10 |
| 7 | EA0130 | | | | | | 10 |

* ONLY FOR 18 HC

The Stubby collets allow the use of the small nozzles of the 9/20 series on the 17/18/26 torch bodies.

