







ERGOCUT A 51

CE EN60974-7

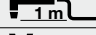

CODE	↔		
PA1430	4 m	12.5'	 1/8 GAS

TECHNICAL DATA		
ERGOCUT A 51		
 HF		
 1 m	0,4 kg	0.88 lb
V PEAK	500	
	5 bar	
	165 l/min	
X 60%	50A	
X 100%	40A	
	10-15 mm	13/32"-19/32"

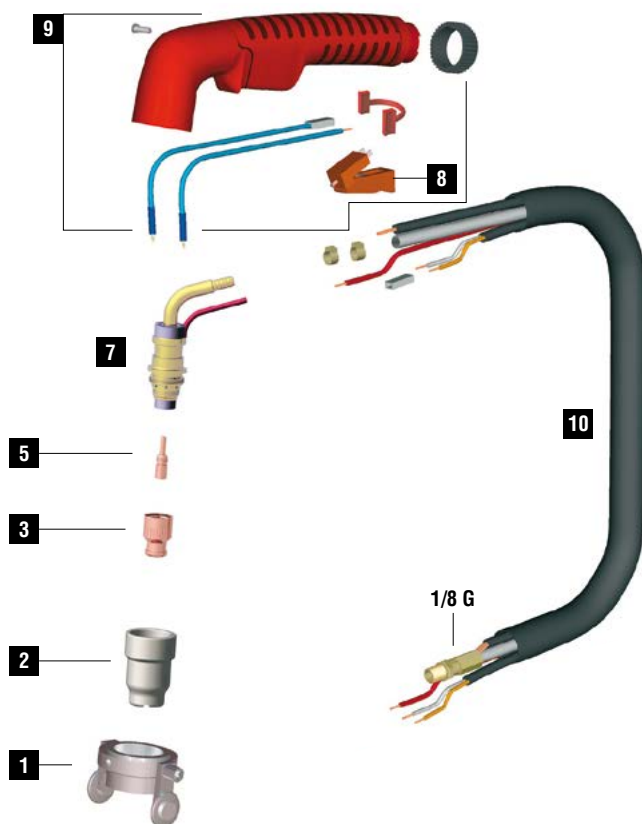

	CODE		Description	Ø		↔		CONTACT		DRAG		GOUGING	REF	
1	CV0037		stand off guide	24,3 mm		31 mm								1
2	PC0150		ceramic nozzle			39 mm								10
2	PC0151		long ceramic nozzle			54 mm								10
3	PD0150-08		30 A	0,8 mm	.030"	21,8 mm							-	10
3	PD0150-10		50 A	1,0 mm	.040"	21,8 mm							-	10
3	PD0151-08		30 A	0,8 mm	.030"	36,8 mm							-	10
5	PR0150		electrode			23 mm								10
5	PR0151		electrode			38 mm								10

	CODE		Description	
7	PF0150		Ergocut A 51 torch head	1
8	BX0020		trigger	10
9	TP0120		handle kit	1

	CODE		Description	
10	PH1335		cable assembly - 4 m / 12' - 1/8 G	1
10	PH0340		power cable - 4 m / 12.5' - 1/8 G	1

STANDARD

CONTACT SHORT CONTACT LONG DRAG SHORT DRAG LONG GOUGING