

**TURBOPLUS  
TR 480A**

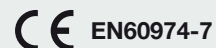

|      |   |  |
|------|---|--|
| CODE | ↔ |  |
|------|---|--|

|        |       |  |
|--------|-------|--|
| MB0920 | 3,3 m |  |
| MB0921 | 4,3 m |  |
| MB0922 | 5,3 m |  |

| TECHNICAL DATA |  |  |
|----------------|--|--|
|----------------|--|--|

|               |                     |                |
|---------------|---------------------|----------------|
|               |                     |                |
|               | 1.50 kg             |                |
|               | 1,2 ÷ 1,6 mm        | .045" ÷ .1/16" |
| <b>X 100%</b> | 480A CO2 - 420A Mix |                |
|               | 125 m³/h            |                |
|               | 1350 mm/H2O         |                |

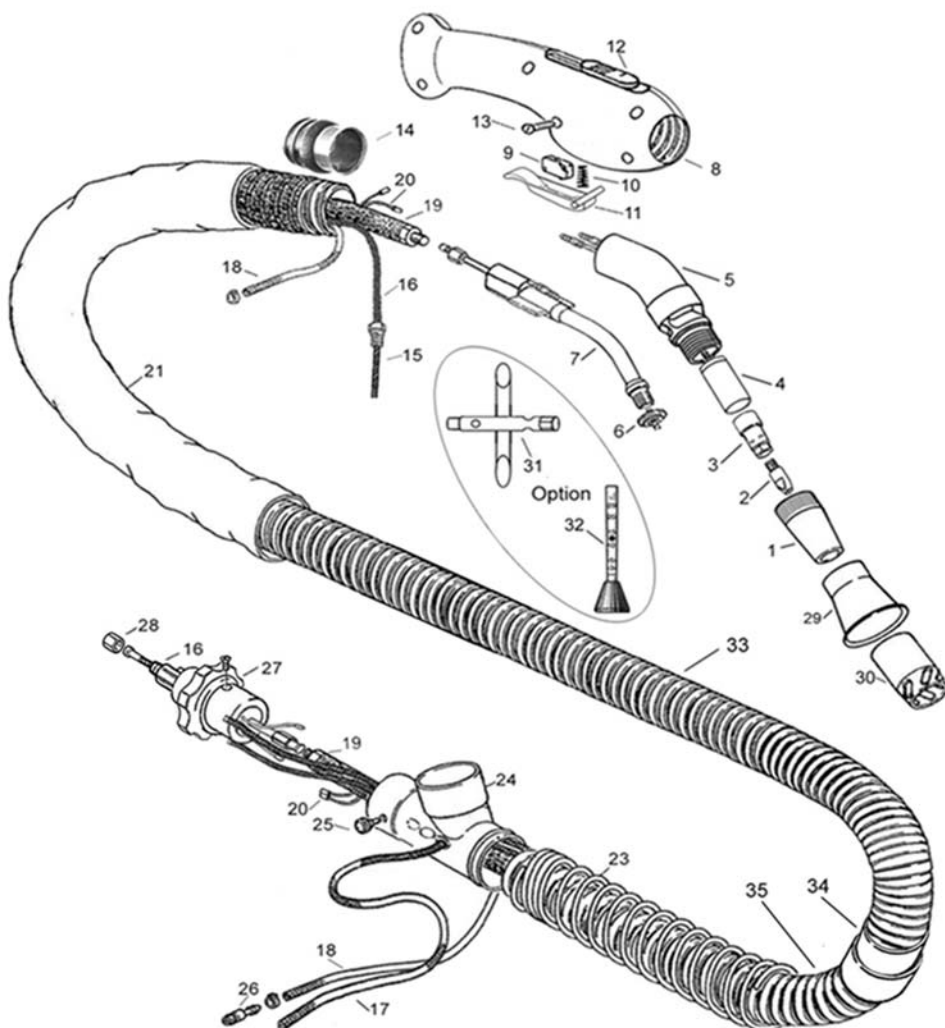

**EXTERNAL PROTECTION**  
Rubber and velcro Ø 40

MQ0195 . 2,5 m  
MQ0196 . 3,5 m  
MQ0197 . 4,5 m

**REFRIGERANT LIQUID**  
UTI000158

|    | CODE      |  |                                   | Ø            |               |       | REF      |          |   |
|----|-----------|--|-----------------------------------|--------------|---------------|-------|----------|----------|---|
| 1  | MC0193    |  | Ø 16 mm                           | 16 mm        |               | 48 mm |          | 1        |   |
| 2  | MD0005-12 |  | M8 - Cu                           | 1,2 mm       | .045"         | 30 mm | 140.0442 | 20       |   |
| 2  | MD0005-16 |  | M8 - Cu                           | 1,6 mm       | 1/16"         | 30 mm | 140.0587 | 20       |   |
| 2  | MD0005-82 |  | M8 - CuCrZr                       | 1,2 mm       | .045"         | 30 mm | 140.0445 | 20       |   |
| 2  | MD0005-86 |  | M8 - CuCrZr                       | 1,6 mm       | 1/16"         | 30 mm | 140.0590 | 20       |   |
| 3  | ME0442    |  | Diffuser M8 L30                   |              |               | 30 mm |          |          |   |
| 15 | GM0510    |  | red steel liner                   | 1,0 ÷ 1,2 mm | .040" ÷ .045" | 3 m   | 10'      | 124.0026 | 1 |
| 15 | GM0511    |  | red steel liner                   | 1,0 ÷ 1,2 mm | .040" ÷ .045" | 4 m   | 12'      | 124.0031 | 1 |
| 15 | GM0512    |  | red steel liner                   | 1,0 ÷ 1,2 mm | .040" ÷ .045" | 5 m   | 16.4'    | 124.0035 | 1 |
| 15 | GM0540    |  | yellow steel liner                | 1,2 ÷ 1,6 mm | .045" ÷ 1/16" | 3 m   | 10'      | 124.0041 | 1 |
| 15 | GM0541    |  | yellow steel liner                | 1,2 ÷ 1,6 mm | .045" ÷ 1/16" | 4 m   | 12'      | 124.0042 | 1 |
| 15 | GM0542    |  | yellow steel liner                | 1,2 ÷ 1,6 mm | .045" ÷ 1/16" | 5 m   | 16.4'    | 124.0044 | 1 |
| 15 | GM0736    |  | black Nylon® + 12% Graphite liner | 1,2 ÷ 1,6 mm | .045" ÷ 1/16" | 3 m   | 10'      |          | 1 |
| 15 | GM0737    |  | black Nylon® + 12% Graphite liner | 1,2 ÷ 1,6 mm | .045" ÷ 1/16" | 4 m   | 12'      |          | 1 |
| 15 | GM0738    |  | black Nylon® + 12% Graphite liner | 1,2 ÷ 1,6 mm | .045" ÷ 1/16" | 5 m   | 16.4'    |          | 1 |

|  | CODE |  |  |
|--|------|--|--|
|--|------|--|--|

|    |        |  |   |
|----|--------|--|---|
| 4  | MQ0355 | Cylindric Insulator L.33               |   |
| 5  | MG0244 | mig torch head 50° Ø32                 | 1 |
| 6  | MQ0356 | Insulator D.19                         |   |
| 7  | MG0243 | mig torch head                         | 1 |
| 8  | MP0211 | handle                                 | 1 |
| 9  | BX0021 | trigger                                | 5 |
| 10 | EA1270 | Spiral spring                          |   |
| 11 | BW0593 | Lever for microswitches                |   |
| 12 | BW0592 | Cursor control apiration               |   |
| 13 | EA1271 | Handle screws                          |   |
| 14 | FB0690 | Metal turning connection for hose D.40 |   |
| 16 | MH0517 | 3 m                                    |   |
| 16 | MH0518 | 4 m                                    |   |
| 16 | MH0519 | 5 m                                    |   |
| 17 | MQ0199 | Water outlet hose 0.6 m                |   |
| 18 | QB0014 | Water inlet hose 4 m                   |   |
| 18 | QB0117 | Water inlet hose 3 m                   |   |
| 18 | QB0118 | Water inlet hose 5 m                   |   |
| 19 | MH0203 | 3 m - 10'                              |   |
| 19 | MH0204 | 4 m - 12'                              |   |

|  | CODE |  |  |
|--|------|--|--|
|--|------|--|--|

|    |        |   |    |
|----|--------|---|----|
| 19 | MH0205 | 5 m - 16.4'                                 |    |
| 20 | BX1042 | Control Lead 3m with connectors             |    |
| 20 | BX1043 | Control Lead 4m with connectors             |    |
| 20 | BX1044 | Control Lead 5m with connectors             |    |
| 21 | MQ0188 | cover hose                                  | 1  |
| 23 | EA1380 | Hose support spring                         |    |
| 24 | BW0498 | Smoke deviating connection D.50 H2O         |    |
| 25 | EA1275 | Fixing screw for smoke deviating connection |    |
| 26 | FA3020 | water - Ø 6 mm                              | 10 |
| 27 | AR0233 | EURO connection                             | 1  |
| 28 | FA0291 | Nut stops internal liner                    | 1  |
| 29 | FB0182 | Short cilindric suction device D.32         |    |
| 30 | FB0707 | Cylindric suction device D.32               |    |
| 31 | EA1274 | Scraper gas nozzle                          |    |
| 32 | EA1273 | Argon-CO2 gas flow checker                  |    |
| 33 | MQ0190 | Pipe flue pipe 3.5 m D.40 Soft              |    |
| 33 | MQ0307 | Pipe flue pipe 2.5 m D.40 Soft              |    |
| 33 | MQ0308 | Pipe flue pipe 4.5 m D.40 Soft              |    |
| 34 | FA0062 | Intermediate fitting D.50/40                | 1  |
| 35 | MQ0135 | Pipe flue pipe 0.3 m D.50 Soft              |    |

STANDARD

# TURBOPLUS TR 480A FCT







CE EN60974-7

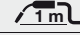

|      |   |   |
|------|---|---|
| CODE | ↔ | ☐ |
|------|---|---|

|        |       |   |
|--------|-------|---|
| MB2920 | 3,3 m |  |
| MB2921 | 4,3 m |   |
| MB2922 | 5,3 m |   |
|        |       | EURO  |

| TECHNICAL DATA |  |  |
|----------------|--|--|
|----------------|--|--|

|   |                     |                |
|---|---------------------|----------------|
|  |                     |                |
|  | 1,50 kg             |                |
|  | 1,2 ÷ 1,6 mm        | .045" ÷ .1/16" |
|  | 480A CO2 - 420A Mix |                |
|  | 125 m³/h            |                |
|  | 1350 mm/H2O         |                |

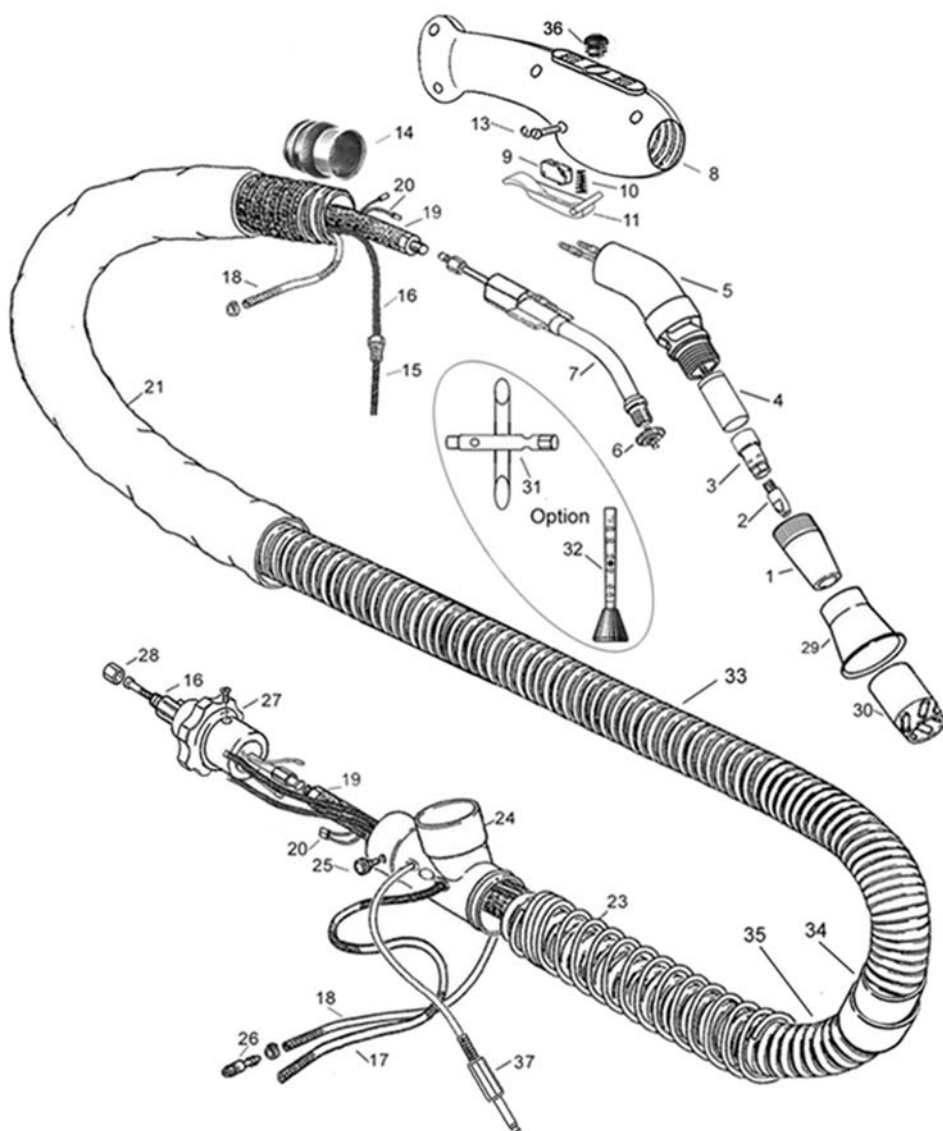

## EXTERNAL PROTECTION

Rubber and velcro Ø 40

- MQ0195 . 2,5 m
- MQ0196 . 3,5 m
- MQ0197 . 4,5 m

## REFRIGERANT LIQUID

UTI000158



|    | CODE      |  |                                   | ∅            |               |       | REF      |          |   |
|----|-----------|--|-----------------------------------|--------------|---------------|-------|----------|----------|---|
| 1  | MC0193    |  | ∅ 16 mm                           | 16 mm        |               | 48 mm |          | 1        |   |
| 2  | MD0005-12 |  | M8 - Cu                           | 1,2 mm       | .045"         | 30 mm | 140.0442 | 20       |   |
| 2  | MD0005-16 |  | M8 - Cu                           | 1,6 mm       | 1/16"         | 30 mm | 140.0587 | 20       |   |
| 2  | MD0005-82 |  | M8 - CuCrZr                       | 1,2 mm       | .045"         | 30 mm | 140.0445 | 20       |   |
| 2  | MD0005-86 |  | M8 - CuCrZr                       | 1,6 mm       | 1/16"         | 30 mm | 140.0590 | 20       |   |
| 3  | ME0442    |  | Diffuser M8 L30                   |              |               | 30 mm |          |          |   |
| 15 | GM0510    |  | red steel liner                   | 1,0 ÷ 1,2 mm | .040" ÷ .045" | 3 m   | 10'      | 124.0026 | 1 |
| 15 | GM0511    |  | red steel liner                   | 1,0 ÷ 1,2 mm | .040" ÷ .045" | 4 m   | 12'      | 124.0031 | 1 |
| 15 | GM0512    |  | red steel liner                   | 1,0 ÷ 1,2 mm | .040" ÷ .045" | 5 m   | 16.4'    | 124.0035 | 1 |
| 15 | GM0540    |  | yellow steel liner                | 1,2 ÷ 1,6 mm | .045" ÷ 1/16" | 3 m   | 10'      | 124.0041 | 1 |
| 15 | GM0541    |  | yellow steel liner                | 1,2 ÷ 1,6 mm | .045" ÷ 1/16" | 4 m   | 12'      | 124.0042 | 1 |
| 15 | GM0542    |  | yellow steel liner                | 1,2 ÷ 1,6 mm | .045" ÷ 1/16" | 5 m   | 16.4'    | 124.0044 | 1 |
| 15 | GM0736    |  | black Nylon® + 12% Graphite liner | 1,2 ÷ 1,6 mm | .045" ÷ 1/16" | 3 m   | 10'      |          | 1 |
| 15 | GM0737    |  | black Nylon® + 12% Graphite liner | 1,2 ÷ 1,6 mm | .045" ÷ 1/16" | 4 m   | 12'      |          | 1 |
| 15 | GM0738    |  | black Nylon® + 12% Graphite liner | 1,2 ÷ 1,6 mm | .045" ÷ 1/16" | 5 m   | 16.4'    |          | 1 |

|  | CODE |  |  |
|--|------|--|--|
|--|------|--|--|

|    |        |  |   |
|----|--------|--|---|
| 4  | MQ0355 | Cylindric insulator L.33               |   |
| 5  | MG0244 | mig torch head                         | 1 |
| 6  | MQ0356 | Insulator D.19                         |   |
| 7  | MG0243 | mig torch head                         | 1 |
| 8  | MP0213 | handle                                 | 1 |
| 9  | BX0021 | trigger                                | 5 |
| 10 | EA1270 | Spiral spring                          |   |
| 11 | BW0593 | Lever for microswitches                |   |
| 12 | BW0592 | Cursor control apiration               |   |
| 13 | EA1271 | Handle screws                          |   |
| 14 | FB0690 | Metal turning connection for hose D.40 |   |
| 16 | MH0517 | 3 m                                    |   |
| 16 | MH0518 | 4 m                                    |   |
| 16 | MH0519 | 5 m                                    |   |
| 17 | MQ0199 | Water outlet hose 0.6 m                |   |
| 18 | QB0014 | Water inlet hose 4 m                   |   |
| 18 | QB0117 | Water inlet hose 3 m                   |   |
| 18 | QB0118 | Water inlet hose 5 m                   |   |
| 19 | MH0203 | 3 m - 10'                              |   |
| 19 | MH0204 | 4 m - 12'                              |   |
| 19 | MH0205 | 5 m - 16.4'                            |   |

|  | CODE |  |  |
|--|------|--|--|
|--|------|--|--|

|    |        |   |    |
|----|--------|---|----|
| 20 | BX1042 | Control Lead 3m with connectors             |    |
| 20 | BX1043 | Control Lead 4m with connectors             |    |
| 20 | BX1044 | Control Lead 5m with connectors             |    |
| 21 | MQ0188 | cover hose                                  | 1  |
| 23 | EA1380 | Hose support spring                         |    |
| 24 | BW0498 | Smoke deviating connection D.50 H2O         |    |
| 25 | EA1275 | Fixing screw for smoke deviating connection |    |
| 26 | FA3020 | water - ∅ 6 mm                              | 10 |
| 27 | AR0233 | EURO connection                             | 1  |
| 28 | FA0291 | Nut stops internal liner                    | 1  |
| 29 | FB0182 | Short cilindric suction device D.32         |    |
| 30 | FB0707 | Cylindric suction device D.32               |    |
| 31 | EA1274 | Scraper gas nozzle                          |    |
| 32 | EA1273 | Argon-CO2 gas flow checker                  |    |
| 33 | MQ0190 | Pipe flue pipe 3.5 m D.40 Soft              |    |
| 33 | MQ0307 | Pipe flue pipe 2.5 m D.40 Soft              |    |
| 33 | MQ0308 | Pipe flue pipe 4.5 m D.40 Soft              |    |
| 34 | FA0062 | Intermediate fitting D.50/40                | 1  |
| 35 | MQ0135 | Pipe flue pipe 0.3 m D.50 Soft              |    |
| 36 | BX0718 | FCT trigger                                 |    |
| 37 | BX0744 | FCT cable with pin Jack without buttom      |    |

STANDARD