

**TURBOPLUS
TR 400A**









CE EN60974-7



CODE	↔	☐
------	---	---

MB0909	3,3 m	
MB0910	4,3 m	
MB0911	5,3 m	
		EURO

TECHNICAL DATA		
----------------	--	--

		
	1,40 kg	3,09 lb
	1,2 ÷ 1,6 mm	.045" ÷ .1/16"
	400A CO2 - 350A Mix	
	125 m³/h	
	1350 mm/H2O	

EXTERNAL PROTECTION
Rubber and velcro Ø 40

MQ0195 . 2,5 m
MQ0196 . 3,5 m
MQ0197 . 4,5 m

REFRIGERANT LIQUID
UTI000158

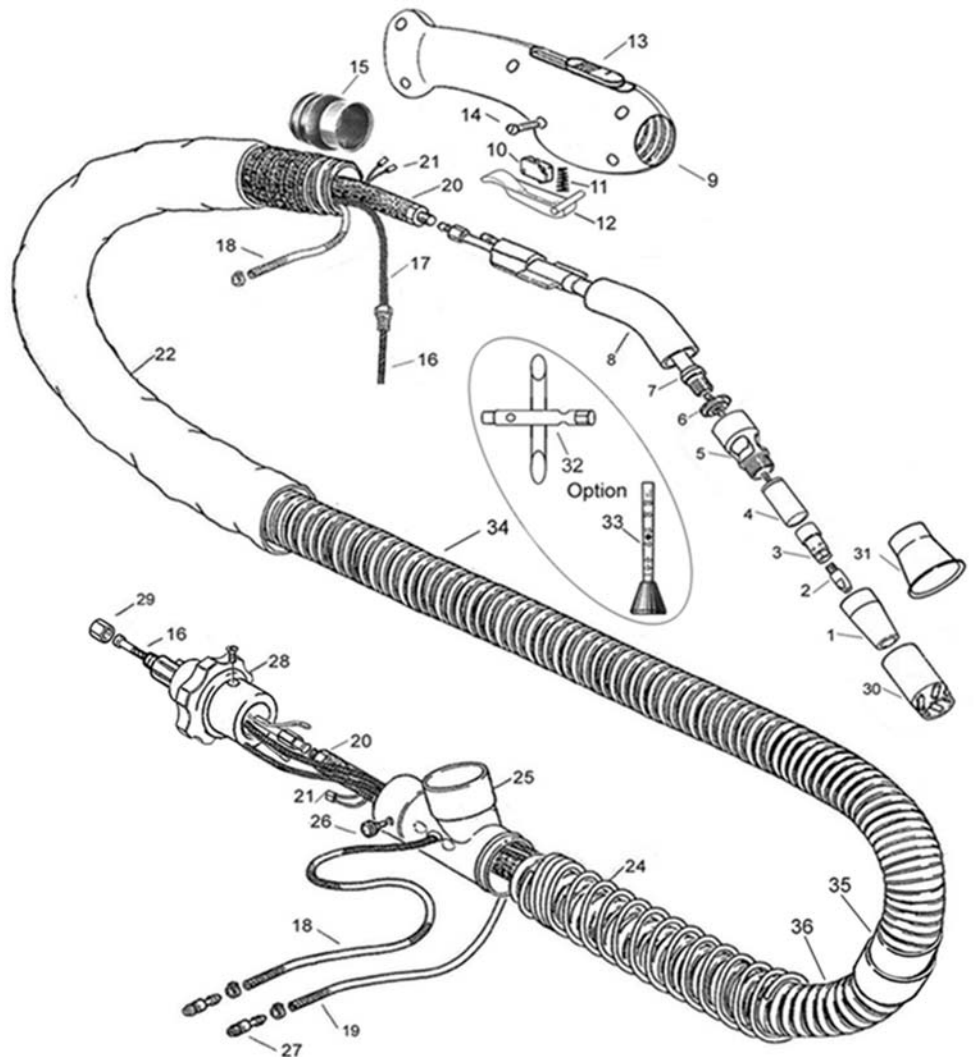
	CODE			Ø			REF	
1	MC0474		Ø14mm nozzle round thread	14 mm				1
1	MC0475		Ø16mm nozzle round thread	16 mm	5/8"			
2	MD0005-12		M8 - Cu	1,2 mm	.045"	30 mm	140.0442	20
2	MD0005-16		M8 - Cu	1,6 mm	1/16"	30 mm	140.0587	20
2	MD0005-82		M8 - CuCrZr	1,2 mm	.045"	30 mm	140.0445	20
2	MD0005-86		M8 - CuCrZr	1,6 mm	1/16"	30 mm	140.0590	20
3	ME0442		Diffuser M8 L30			30 mm		
16	GM0510		red steel liner	1,0 ÷ 1,2 mm	.040" ÷ .045"	3 m	10'	124.0026 1
16	GM0511		red steel liner	1,0 ÷ 1,2 mm	.040" ÷ .045"	4 m	12'	124.0031 1
16	GM0512		red steel liner	1,0 ÷ 1,2 mm	.040" ÷ .045"	5 m	16.4'	124.0035 1
16	GM0540		yellow steel liner	1,2 ÷ 1,6 mm	.045" ÷ 1/16"	3 m	10'	124.0041 1
16	GM0541		yellow steel liner	1,2 ÷ 1,6 mm	.045" ÷ 1/16"	4 m	12'	124.0042 1
16	GM0542		yellow steel liner	1,2 ÷ 1,6 mm	.045" ÷ 1/16"	5 m	16.4'	124.0044 1
16	GM0736		black Nylon® + 12% Graphite liner	1,2 ÷ 1,6 mm	.045" ÷ 1/16"	3 m	10'	1 1
16	GM0737		black Nylon® + 12% Graphite liner	1,2 ÷ 1,6 mm	.045" ÷ 1/16"	4 m	12'	1 1
16	GM0738		black Nylon® + 12% Graphite liner	1,2 ÷ 1,6 mm	.045" ÷ 1/16"	5 m	16.4'	1 1

	CODE			
4	MQ0355		Cylindric insulator L.33	
5	FB0695		Threaded suction head round D.32	
6	MQ0356		Insulator D.19	
7	MG0250		mig torch head	1
8	FB0682		mig torch head 50° D.30	
9	MP0211		handle	1
10	BX0021		trigger	5
11	EA1270		Spiral spring	
12	BW0593		Lever for microswitches	
13	BW0592		Cursor control apiration	
14	EA1271		Handle screws	
15	FB0690		Metal turning connection for hose D.40	
17	MH0517		3 m	
17	MH0518		4 m	
17	MH0519		5 m	
18	QB0014		Water inlet hose 4 m	
18	QB0117		Water inlet hose 3 m	
18	QB0118		Water inlet hose 5 m	
19	MQ0199		Water outlet hose 0.6 m	
20	MH0203		3 m - 10'	
20	MH0204		4 m - 12'	

	CODE			
20	MH0205		5 m - 16.4'	
21	BX1042		Control Lead 3m with connectors	
21	BX1043		Control Lead 4m with connectors	
21	BX1044		Control Lead 5m with connectors	
22	MQ0188		cover hose	1
24	EA1380		Hose support spring	
25	BW0498		Smoke deviating connection D.50 H2O	
26	EA1275		Fixing screw for smoke deviating connection	
27	FA3020		water - Ø 6 mm	10
28	AR0233		EURO connection	1
29	FA0291		Nut stops internal liner	1
30	FB0707		Cylindric suction device D.32	
31	FB0182		Short cilindric suction device D.32	
32	EA1274		Scraper gas nozzle	
33	EA1273		Argon-CO2 gas flow checker	
34	MQ0190		Pipe flue pipe 3.5 m D.40 Soft	
34	MQ0307		Pipe flue pipe 2.5 m D.40 Soft	
34	MQ0308		Pipe flue pipe 4.3 m D.40 Soft	
35	FA0062		Intermediate fitting D.50/40	1
36	MQ0135		Pipe flue pipe 0.3 m D.50 Soft	

STANDARD

TURBOPLUS TR 400A FCT







CE EN60974-7

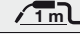

CODE	↔	☐
------	---	---

MB2909	3,3 m	
MB2910	4,3 m	
MB2911	5,3 m	
		EURO

TECHNICAL DATA		
----------------	--	--

		
	1,40 kg	
	1,2 ÷ 1,6 mm	.045" ÷ .1/16"
	400A CO2 - 350A Mix	
	125 m³/h	
	1350 mm/H2O	

EXTERNAL PROTECTION
Rubber and velcro Ø 40

MQ0195 . 2,5 m
MQ0196 . 3,5 m
MQ0197 . 4,5 m

REFRIGERANT LIQUID
UTI000158

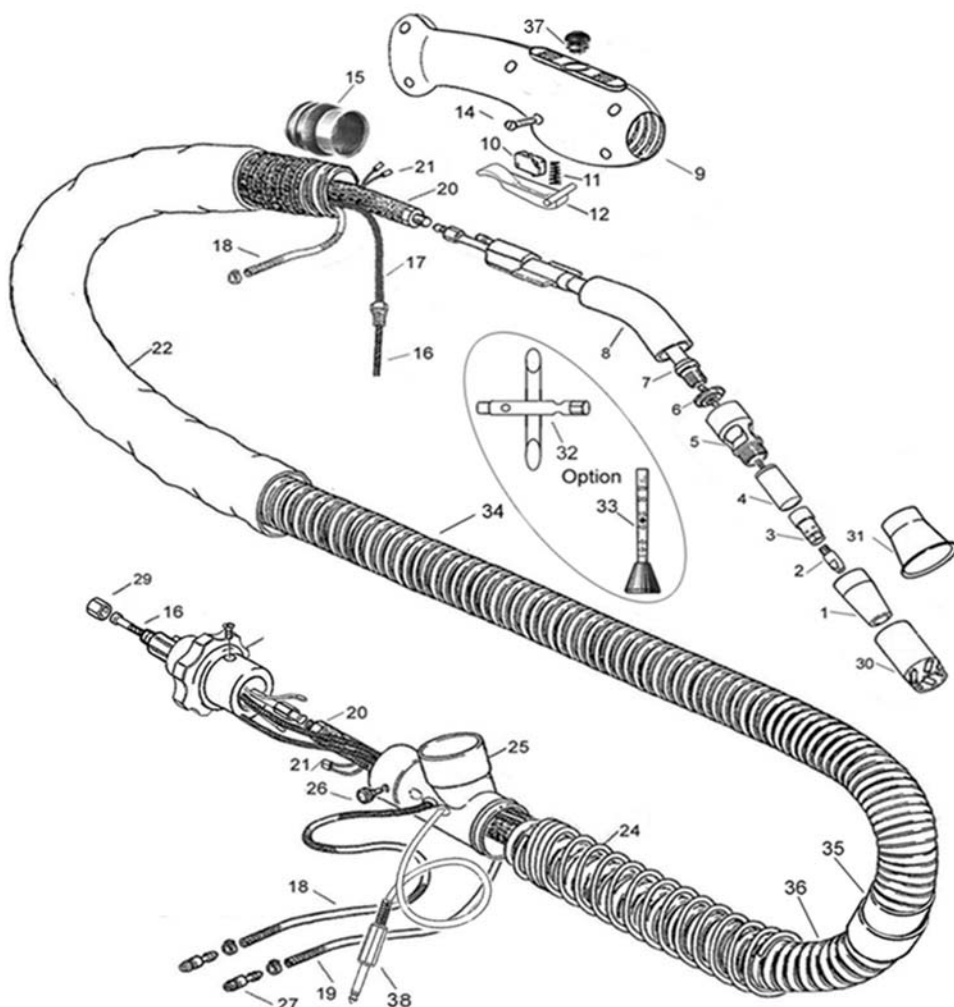
	CODE			Ø			REF	
1	MC0474		Ø14mm nozzle round thread	14 mm				1
1	MC0475		Ø16mm nozzle round thread	16 mm	5/8"			
2	MD0005-12		M8 - Cu	1,2 mm	.045"	30 mm	140.0442	20
2	MD0005-16		M8 - Cu	1,6 mm	1/16"	30 mm	140.0587	20
2	MD0005-82		M8 - CuCrZr	1,2 mm	.045"	30 mm	140.0445	20
2	MD0005-86		M8 - CuCrZr	1,6 mm	1/16"	30 mm	140.0590	20
3	ME0442		Diffuser M8 L30			30 mm		
16	GM0510		red steel liner	1,0 ÷ 1,2 mm	.040" ÷ .045"	3 m	10'	124.0026 1
16	GM0511		red steel liner	1,0 ÷ 1,2 mm	.040" ÷ .045"	4 m	12'	124.0031 1
16	GM0512		red steel liner	1,0 ÷ 1,2 mm	.040" ÷ .045"	5 m	16.4'	124.0035 1
16	GM0540		yellow steel liner	1,2 ÷ 1,6 mm	.045" ÷ 1/16"	3 m	10'	124.0041 1
16	GM0541		yellow steel liner	1,2 ÷ 1,6 mm	.045" ÷ 1/16"	4 m	12'	124.0042 1
16	GM0542		yellow steel liner	1,2 ÷ 1,6 mm	.045" ÷ 1/16"	5 m	16.4'	124.0044 1
16	GM0736		black Nylon® + 12% Graphite liner	1,2 ÷ 1,6 mm	.045" ÷ 1/16"	3 m	10'	1
16	GM0737		black Nylon® + 12% Graphite liner	1,2 ÷ 1,6 mm	.045" ÷ 1/16"	4 m	12'	1
16	GM0738		black Nylon® + 12% Graphite liner	1,2 ÷ 1,6 mm	.045" ÷ 1/16"	5 m	16.4'	1

	CODE		
4	MQ0355	Cylindric Insulator L.33	
5	FB0695	Threaded suction head round D.32	
6	MQ0356	Insulator D.19	
7	MG0250	mig torch head	1
8	FB0682	mig torch head 50° D.30	
9	MP0213	handle	1
10	BX0021	trigger	5
11	EA1270	Spiral spring	
12	BW0593	Lever for microswitches	
13	BW0592	Cursor control apiration	
14	EA1271	Handle screws	
15	FB0690	Metal turning connection for hose D.40	
17	MH0517	3 m	
17	MH0518	4 m	
17	MH0519	5 m	
18	QB0014	Water inlet hose 4 m	
18	QB0117	Water inlet hose 3 m	
18	QB0118	Water inlet hose 5 m	
19	MQ0199	Water outlet hose 0.6 m	
20	MH0203	3 m - 10'	
20	MH0204	4 m - 12'	
20	MH0205	5 m - 16.4'	

	CODE		
21	BX1042	Control Lead 3m with connectors	
21	BX1043	Control Lead 4m with connectors	
21	BX1044	Control Lead 5m with connectors	
22	MQ0188	cover hose	1
24	EA1380	Hose support spring	
25	BW0498	Smoke deviating connection D.50 H2O	
26	EA1275	Fixing screw for smoke deviating connection	
27	FA3020	water - Ø 6 mm	10
28	AR0233	EURO connection	1
29	FA0291	Nut stops internal liner	1
30	FB0707	Cylindric suction device D.32	
31	FB0182	Short cilindric suction device D.32	
32	EA1274	Scraper gas nozzle	
33	EA1273	Argon-CO2 gas flow checker	
34	MQ0190	Pipe flue pipe 3.5 m D.40 Soft	
34	MQ0307	Pipe flue pipe 2.5 m D.40 Soft	
34	MQ0308	Pipe flue pipe 4.5 m D.40 Soft	
35	FA0062	Intermediate fitting D.50/40	1
36	MQ0135	Pipe flue pipe 0.3 m D.50 Soft	
37	BX0718	FCT trigger	
38	BX0744	FCT cable with pin Jack without bottom	

STANDARD