

EXTRAPLUS 500



CE EN60974-7



CODE	↔	
------	---	--

MB0905	3,3 m		EURO
MB0906	4,3 m		
MB0907	5,3 m		

TECHNICAL DATA		
----------------	--	--

	1,70 kg	3.31 lb
	1,2 ÷ 1,6 mm	.045" ÷ .1/16"
X 100%	500A CO2 - 450A Mix	
	125 m³/h	
	1350 mm/H2O	

EXTERNAL PROTECTION
Rubber and velcro Ø 40

MQ0195 . 2,5 m
MQ0196 . 3,5 m
MQ0197 . 4,5 m

REFRIGERANT LIQUID
UTI000158

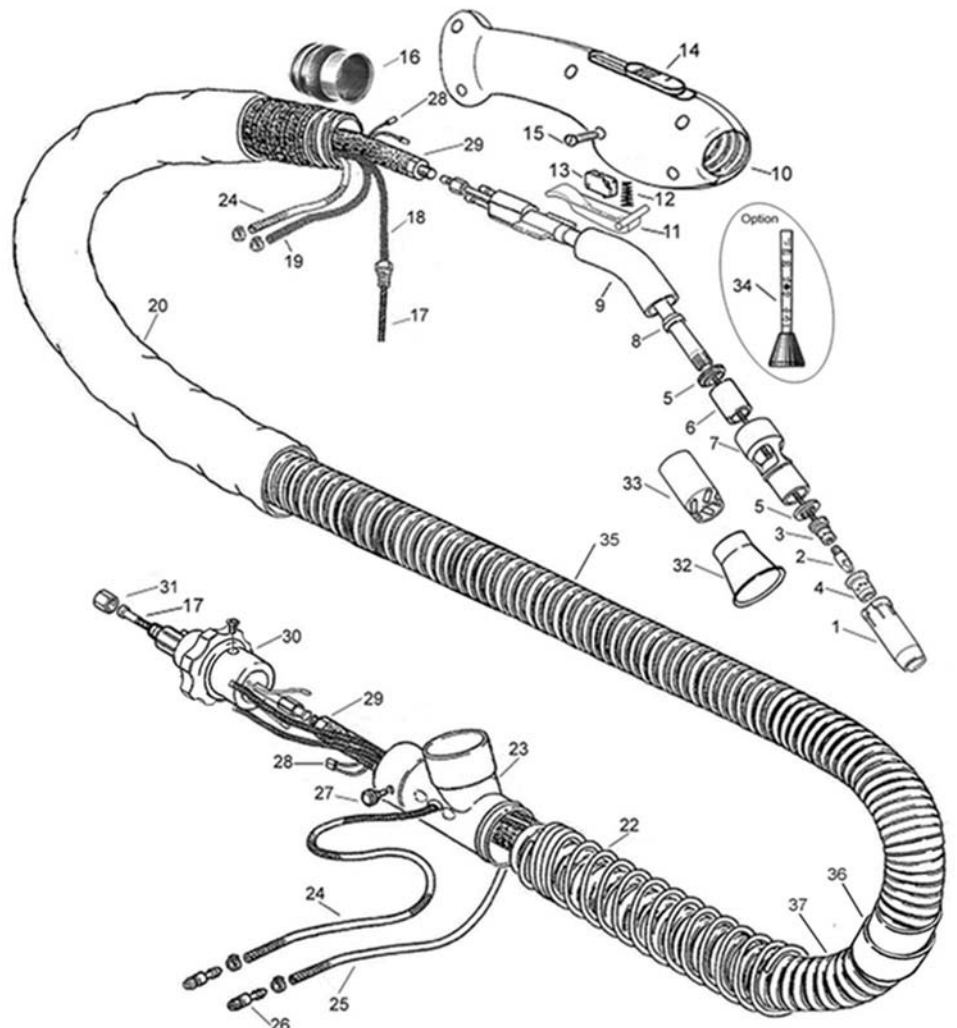

	CODE			Ø		↔	REF		
1	MC0268		Ø 16 mm 2,5 mm	16 mm	5/8"	76 mm	145.0085	10	
1	MC0291		Ø 20 mm 2,5 mm	20 mm		76 mm	145.0051	10	
2	MD0005-12		M8 - Cu	1,2 mm	.045"	30 mm	140.0442	20	
2	MD0005-16		M8 - Cu	1,6 mm	1/16"	30 mm	140.0587	20	
2	MD0005-82		M8 - CuCrZr	1,2 mm	.045"	30 mm	140.0445	20	
2	MD0005-86		M8 - CuCrZr	1,6 mm	1/16"	30 mm	140.0590	20	
3	ME0390		M8 - copper			25 mm	-	10	
4	ME0079		plastic			29 mm	300029	10	
4	ME0579		ceramic	16 mm	5/8"	28 mm	-	10	
17	GM0510		red steel liner	1,0 ÷ 1,2 mm	.040" ÷ .045"	3 m	10'	124.0026	1
17	GM0511		red steel liner	1,0 ÷ 1,2 mm	.040" ÷ .045"	4 m	12'	124.0031	1
17	GM0512		red steel liner	1,0 ÷ 1,2 mm	.040" ÷ .045"	5 m	16.4'	124.0035	1
17	GM0540		yellow steel liner	1,2 ÷ 1,6 mm	.045" ÷ 1/16"	3 m	10'	124.0041	1
17	GM0541		yellow steel liner	1,2 ÷ 1,6 mm	.045" ÷ 1/16"	4 m	12'	124.0042	1
17	GM0542		yellow steel liner	1,2 ÷ 1,6 mm	.045" ÷ 1/16"	5 m	16.4'	124.0044	1
17	GM0736		black Nylon® + 12% Graphite liner	1,2 ÷ 1,6 mm	.045" ÷ 1/16"	3 m	10'		1
17	GM0737		black Nylon® + 12% Graphite liner	1,2 ÷ 1,6 mm	.045" ÷ 1/16"	4 m	12'		1
17	GM0738		black Nylon® + 12% Graphite liner	1,2 ÷ 1,6 mm	.045" ÷ 1/16"	5 m	16.4'		1

	CODE		
--	------	--	--

5	FB0179	Body torch insulator D.20	
6	FB0180	Bushing insulator L=25 torch body	
7	FB0181	Threaded suction head D.30	
8	MG0395	mig torch head	1
9	FB0178	Extraction nozzle 50° D.30	
10	MP0211	handle	1
11	BW0593	Lever for microswitches	
12	EA1270	Spiral spring	
13	BX0021	trigger	5
14	BW0592	Cursor control apiration	
15	EA1271	Handle screws	
16	FB0690	Metal turning connection for hose D.40	
18	MH0517	3 m	
18	MH0518	4 m	
18	MH0519	5 m	
19	QB0143	Gas pipe 4 mt	
19	QB0144	Gas pipe 5 mt	
20	MQ0188	cover hose	1
22	EA1380	Hose support spring	
23	BW0498	Smoke deviating connection D.50 H2O	
24	QB0014	Water inlet hose 4 m	
24	QB0117	Water inlet hose 3 m	

	CODE		
--	------	--	--

24	QB0118	Water inlet hose 5 m	
25	MQ0199	Water outlet hose 0.6 m	
26	FA3020	water - Ø 6 mm	10
27	EA1275	Fixing screw for smoke deviating connection	
28	BX1042	Control Lead 3m with connectors	
28	BX1043	Control Lead 4m with connectors	
28	BX1044	Control Lead 5m with connectors	
29	MH0203	3 m - 10'	
29	MH0204	4 m - 12'	
29	MH0205	5 m - 16.4'	
30	AR0232	EURO connection	1
31	FA0291	Nut stops internal liner	1
32	FB0182	Short cilindric suction device D.32	
32	FB0183	Long conical suction device D.32	
33	FB0688	Suction device D.32	
34	EA1273	Argon-CO2 gas flow checker	
35	MQ0190	Duct flue pipe 3.5 mt D.40 Soft	
35	MQ0307	Duct flue pipe 2.5 mt D.40 Soft	
35	MQ0308	Duct flue pipe 4.5 mt D.40 Soft	
36	FA0062	Intermediate fitting D.50/40	1
37	MQ0135	Duct flue pipe 0.3 mt D.50 Soft	

STANDARD

EXTRAPLUS 500 FCT







CE EN60974-7

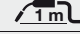

CODE	↔	☐
------	---	---

MB2905	3,3 m	
MB2906	4,3 m	
MB2907	5,3 m	
		EURO

TECHNICAL DATA		
----------------	--	--

		
	1,70 kg	
	1,2 ÷ 1,6 mm	.045" ÷ .1/16"
	500A CO2 - 450A Mix	
	125 m³/h	
	1350 mm/H2O	

EXTERNAL PROTECTION
Rubber and velcro Ø 40

MQ0195 . 2,5 m
MQ0196 . 3,5 m
MQ0197 . 4,5 m

REFRIGERANT LIQUID
UTI000158

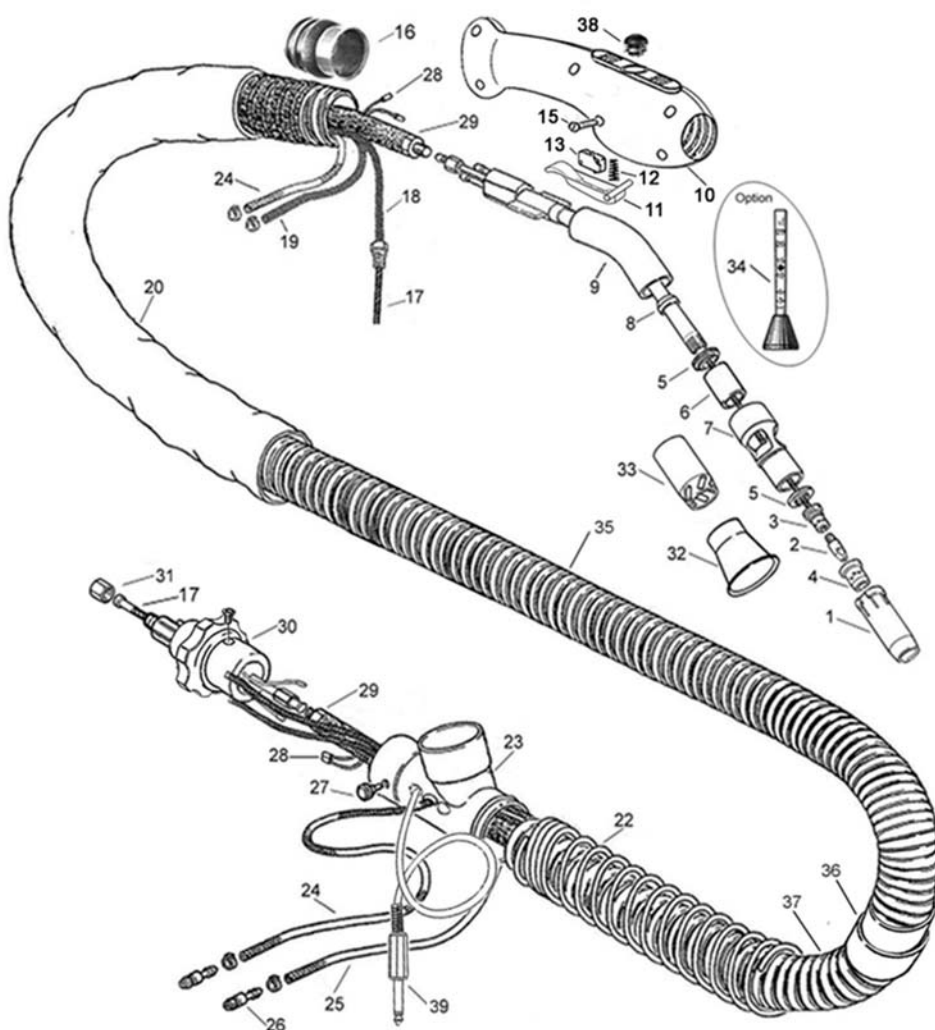
	CODE			Ø			REF		
1	MC0268		Ø 16 mm 2,5 mm	16 mm	5/8"	76 mm	145.0085	10	
1	MC0291		Ø 20 mm 2,5 mm	20 mm		76 mm	145.0051	10	
2	MD0005-12		M8 - Cu	1,2 mm	.045"	30 mm	140.0442	20	
2	MD0005-16		M8 - Cu	1,6 mm	1/16"	30 mm	140.0587	20	
2	MD0005-82		M8 - CuCrZr	1,2 mm	.045"	30 mm	140.0445	20	
2	MD0005-86		M8 - CuCrZr	1,6 mm	1/16"	30 mm	140.0590	20	
3	ME0390		M8 - copper			25 mm	-	10	
4	ME0079		plastic			29 mm	300029	10	
4	ME0579		ceramic	16 mm	5/8"	28 mm	-	10	
17	GM0510		red steel liner	1,0 ÷ 1,2 mm	.040" ÷ .045"	3 m	10'	124.0026	1
17	GM0511		red steel liner	1,0 ÷ 1,2 mm	.040" ÷ .045"	4 m	12'	124.0031	1
17	GM0512		red steel liner	1,0 ÷ 1,2 mm	.040" ÷ .045"	5 m	16.4'	124.0035	1
17	GM0540		yellow steel liner	1,2 ÷ 1,6 mm	.045" ÷ 1/16"	3 m	10'	124.0041	1
17	GM0541		yellow steel liner	1,2 ÷ 1,6 mm	.045" ÷ 1/16"	4 m	12'	124.0042	1
17	GM0542		yellow steel liner	1,2 ÷ 1,6 mm	.045" ÷ 1/16"	5 m	16.4'	124.0044	1
17	GM0736		black Nylon® + 12% Graphite liner	1,2 ÷ 1,6 mm	.045" ÷ 1/16"	3 m	10'		1
17	GM0737		black Nylon® + 12% Graphite liner	1,2 ÷ 1,6 mm	.045" ÷ 1/16"	4 m	12'		1
17	GM0738		black Nylon® + 12% Graphite liner	1,2 ÷ 1,6 mm	.045" ÷ 1/16"	5 m	16.4'		1

	CODE				CODE		
5	FB0179			Body torch insulator D.20	25	MQ0199	Water outlet hose 0.6 m
6	FB0180			Bushing insulator L=25 torch body	26	FA3020	water - Ø 6 mm
7	FB0181			Threaded suction head D.30	27	EA1275	Fixing screw for smoke deviating connection
8	MG0395		1	mig torch head	28	BX1042	Control Lead 3m with connectors
9	FB0178			Extraction nozzle 50° D.30	28	BX1043	Control Lead 4m with connectors
10	MP0213		1	handle	28	BX1044	Control Lead 5m with connectors
11	BX0021		5	trigger	29	MH0203	3 m - 10'
12	EA1270			Spiral spring	29	MH0204	4 m - 12'
13	BW0593			Lever for microswitches	29	MH0205	5 m - 16.4'
15	EA1271			Handle screws	30	AR0232	EURO connection
16	FB0690			Metal turning connection for hose D.40	31	FA0291	Nut stops internal liner
18	MH0517			3 m	32	FB0182	Short cilindric suction device D.32
18	MH0518			4 m	32	FB0183	Long conical suction device D.32
18	MH0519			5 m	33	FB0688	Suction device D.32
19	QB0143			Gas pipe 4 mt	34	EA1273	Argon-CO2 gas flow checker
19	QB0144			Gas pipe 5 mt	35	MQ0190	Duct flue pipe 3.5 mt D.40 Soft
20	MQ0188		1	cover hose	35	MQ0307	Duct flue pipe 2.5 mt D.40 Soft
22	EA1380			Hose support spring	35	MQ0308	Duct flue pipe 4.5 mt D.40 Soft
23	BW0498			Smoke deviating connection D.50 H2O	36	FA0062	Intermediate fitting D.50/40
24	QB0014			Water inlet hose 4 m	37	MQ0135	Duct flue pipe 0.3 mt D.50 Soft
24	QB0117			Water inlet hose 3 m	38	BX0718	FCT trigger
24	QB0118			Water inlet hose 5 m	39	BX0744	FCT cable with pin Jack without bottom

STANDARD