

# TPLUS 25



CODE	↔	
------	---	--

MA3233	3 m	10'	
MA3234	4 m	12'	
MA3235	5 m	16.4'	

### TECHNICAL DATA

	1,25 kg	2,76 lb
<b>V PEAK</b>	113	
	0,8 ÷ 1,2 mm	.030" ÷ .045"
<b>X 60%</b>	230A CO2 - 220A Mix	

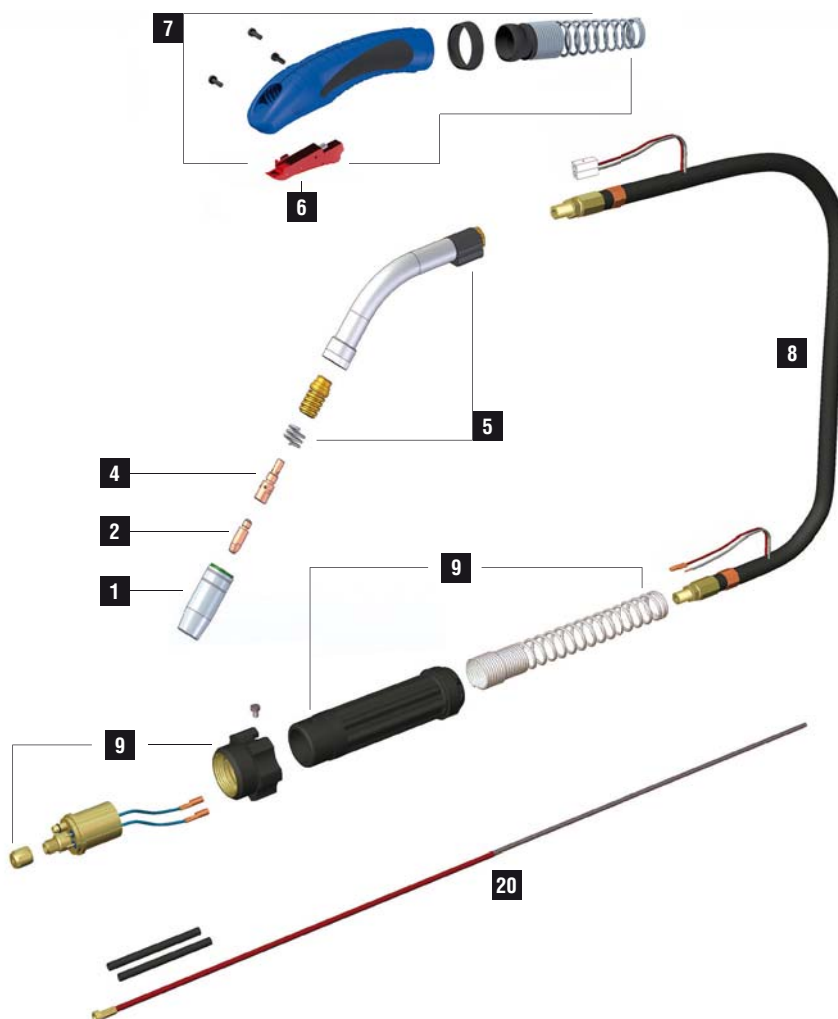

	CODE			Ø		↔	REF		
1	MC0022			11,5 mm		57 mm	145.0124	10	
1	MC0023			15 mm		57 mm	145.0076	10	
1	MC0024			18 mm		57 mm	145.0042	10	
1	MC0025			20 mm		66,5 mm	145.0169	10	
1	MC0265			11 mm		57 mm	-	10	
1	MC0267			14 mm		57 mm		10	
2	MD0009-06		M6 - Cu	0,6 mm	.023"	28 mm	140.0005	20	
2	MD0009-08		M6 - Cu	0,8 mm	.030"	28 mm	140.0051	20	
2	MD0009-09		M6 - Cu	0,9 mm	.035"	28 mm	140.0169	20	
2	MD0009-10		M6 - Cu	1,0 mm	.040"	28 mm	140.0242	20	
2	MD0009-12		M6 - Cu	1,2 mm	.045"	28 mm	140.0379	20	
2	MD0009-14		M6 - Cu	1,4 mm	.052"	28 mm	-	20	
2	MD0009-16		M6 - Cu	1,6 mm	1/16"	28 mm	140.0555	20	
4	ME0016		M6 - opper			35 mm	142.0001	10	
4	ME0060		M6 - copper			37 mm	-	10	
4	ME0216		M6 - brass			35 mm	-	10	
20	GM0510		red steel liner	1,0 ÷ 1,2 mm	.040" ÷ .045"	3 m	10'	124.0026	1
20	GM0511		red steel liner	1,0 ÷ 1,2 mm	.040" ÷ .045"	4 m	12'	124.0031	1
20	GM0512		red steel liner	1,0 ÷ 1,2 mm	.040" ÷ .045"	5 m	16.4'	124.0035	1

	CODE			
5	EA0304			
5	FB0038			1
5	MF0382		mig torch head	1
6	BX0742		trigger	
7	MT0265		handle kit	
8	MH0119		3 m - 10' - 25 mm <sup>2</sup>	

	CODE			
8	MH0124		4 m - 12' - 25 mm <sup>2</sup>	
8	MH0125		5 m - 16.4' - 25 mm <sup>2</sup>	
9	AR0070		EURO connection	1
9	BW0020		Euro nut metal	
9	FA0026		liner nut M10X1	
9	MT0229		Back box kit euro	1

STANDARD

FOR ALL CONSUMABLES SEE PAGE 294