

TMAX 500



CODE	↔	
------	---	--

MA6485	3 m	10'	 EURO
MA6486	4 m	12'	
MA6487	4,6 m	15'	

MA6494T	3 m	10'	 TWECO®
MA6495T	4 m	12'	
MA6496T	4,6 m	15'	

MA6494M	3 m	10'	 MILLER®
MA6495M	4 m	12'	
MA6496M	4,6 m	15'	

MA6494L	3 m	10'	 LINCOLN®
MA6495L	4 m	12'	
MA6496L	4,6 m	15'	

CODE	↔	
------	---	--

MA6494	3 m	10'	 5/8-18 UNF
MA6495	4 m	12'	
MA6496	4,6 m	15'	

+	
AR0170	Tweco® 1/4 KIT
AR0172	Lincoln® KIT
AR0173	Miller® KIT
KIT to be assembled by a qualified technician	

TECHNICAL DATA		
----------------	--	--

	1,4 kg	3.2 lb
V PEAK	113	
	1,0 ÷ 2,0 mm	.040" ÷ 5/64"
X 60%	550A CO2 - 500A Mix	

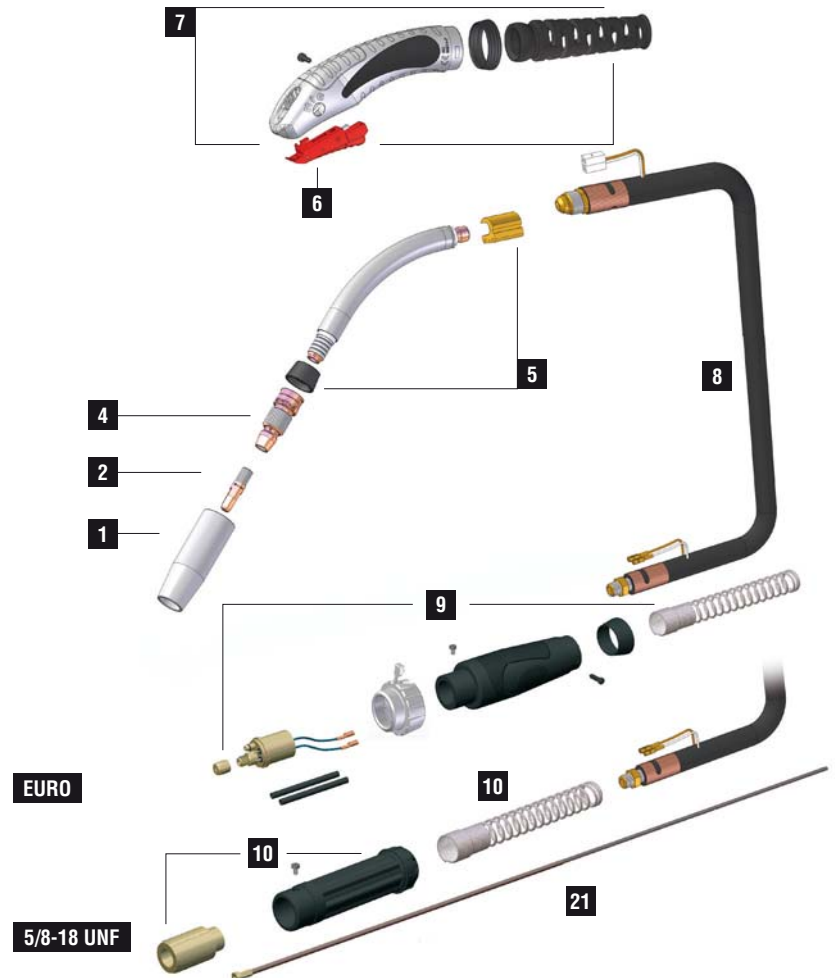

	CODE			Ø			REF	
1	MC0011			16 mm	5/8"	82 mm	-	5
1	MC0012			18 mm		82 mm	-	5
1	MC0013			20 mm		82 mm	-	5
1	MC0298			14 mm		82 mm	-	5
2	MD0250-78		M9X1 - CuCrZr	0,8 mm	.030"	38 mm	-	20
2	MD0250-79		M9X1- CuCrZr	0,9 mm	.035"	38 mm	-	20
2	MD0250-80		M9X1- CuCrZr	1,0 mm	.040"	38 mm	-	20
2	MD0250-82		M9X1- CuCrZr	1,2 mm	.045"	38 mm	-	20
2	MD0250-84		M9X1- CuCrZr	1,4 mm	.052"	38 mm	-	20
2	MD0250-86		M9X1- CuCrZr	1,6 mm	1/16"	38 mm	-	20
2	MD0250-90		M9X1- CuCrZr	2,0 mm	5/64"	38 mm	-	20
2	MD0250-94		M9X1- CuCrZr	2,4 mm	3/32"	38 mm	-	20
4	ME0368			M9X1 copper			51 mm	-
21	GM0013		grey steel liner	1,2 ÷ 1,6 mm	.045" ÷ 1/16"	5 m	16.4'	44-116-15 1

	CODE		
5	FB0653		
5	MF0368		mig torch head 1
5	MQ0340		insulator
6	BX0742		trigger
7	MT0260		handle kit
8	MH0476		3 m - 10' - 65 mm ²
8	MH0477		4 m - 12' - 65 mm ²

	CODE		
8	MH0478		4,6 m - 15' - 65 mm ²
9	AR0083		EURO TW
9	BW0480		Euro nut
9	FA0027		liner nut M11X1
9	MT0077		Back box kit
10	FB0395		5/8-18 UNF
10	MT0228		Back box kit 5/8-18 UNF 1

STANDARD

FOR ALL CONSUMABLES SEE PAGE 294