





# TMAX 4001

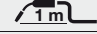

CODE	↔	☐
------	---	---

MB2423	3 m	10'	
MB2424	4 m	12'	
MB2425	5 m	16.4'	

### TECHNICAL DATA

		
	1,3 kg	2.87 lb
<b>V PEAK</b>	113	
	1,2 ÷ 2,4 mm	.030" ÷ 3/32"
<b>X 100%</b>	450A CO <sub>2</sub> - 400A Mix	
	2÷4 bar	
	1,6 l/min	

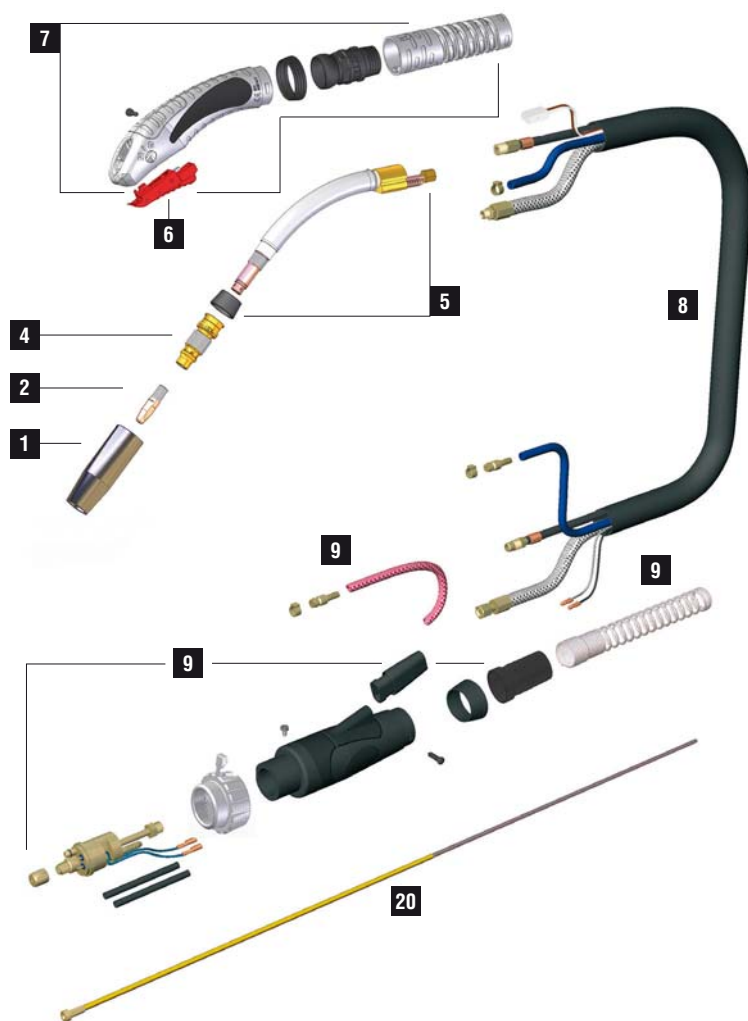

	CODE			Ø		↔	REF		
1	MC0011			16 mm	5/8"		-	5	
1	MC0012			18 mm			-	5	
1	MC0013			20 mm			-	5	
1	MC0298			14 mm			-	5	
2	MD0250-78		M9X1 - CuCrZr	0,8 mm	.030"	38 mm	-	20	
2	MD0250-79		M9X1- CuCrZr	0,9 mm	.035"	38 mm	-	20	
2	MD0250-80		M9X1- CuCrZr	1,0 mm	.040"	38 mm	-	20	
2	MD0250-82		M9X1- CuCrZr	1,2 mm	.045"	38 mm	-	20	
2	MD0250-84		M9X1- CuCrZr	1,4 mm	.052"	38 mm	-	20	
2	MD0250-86		M9X1- CuCrZr	1,6 mm	1/16"	38 mm	-	20	
2	MD0250-90		M9X1- CuCrZr	2,0 mm	5/64"	38 mm	-	20	
2	MD0250-94		M9X1- CuCrZr	2,4 mm	3/32"	38 mm	-	20	
4	ME0141		M9X1 - brass			51 mm	-	5	
20	GM0540		yellow steel liner	1,2 ÷ 1,6 mm	.045" ÷ 1/16"	3 m	10'	124.0041	1
20	GM0541		yellow steel liner	1,2 ÷ 1,6 mm	.045" ÷ 1/16"	4 m	12'	124.0042	1
20	GM0542		yellow steel liner	1,2 ÷ 1,6 mm	.045" ÷ 1/16"	5 m	16.4'	124.0044	1

	CODE		
5	MG0141		1
5	MQ0340		
6	BX0742		
7	MT0261		
9	AR0102		
9	BW0480		
9	FA0026		10
9	MT0101		1

	CODE	CABLE	
8	MN0080	3 m - 10' - 16 mm <sup>2</sup>	
8	MN0081	4 m - 12' - 16 mm <sup>2</sup>	
8	MN0082	5 m - 16.4' - 16 mm <sup>2</sup>	

	CODE	↔	CODE	↔	
8a	BX0733	3 m / 10'	8f	MQ0205	3 m / 10'
8a	BX0734	4 m / 12'	8f	MQ0206	4 m / 12'
8a	BX0735	5 m / 16.4'	8f	MQ0207	5 m / 16.4'
8d	QB0076	3 m / 10'	8g	QB0090	3 m / 10'
8d	QB0077	4 m / 12'	8g	QB0091	4 m / 12'
8d	QB0078	5 m / 16.4'	8g	QB0092	5 m / 16.4'
8e	QA0019	3 m / 10'			
8e	QA0020	4 m / 12'			
8e	QA0021	5 m / 16.4'			

STANDARD

FOR ALL CONSUMABLES SEE PAGE 294