

ERGOPLUS 25FLEX



CE EN60974-7



CODE	↔	
------	---	--

MA7220-03	3 m	10'	 EURO
MA7220-04	4 m	12'	
MA7220-05	5 m	16.4'	

TECHNICAL DATA

	1,25 kg	2,76 lb
V PEAK	113	
	0,8 ÷ 1,2 mm	.030" ÷ .045"
X 60%	230A CO2 - 220A Mix	

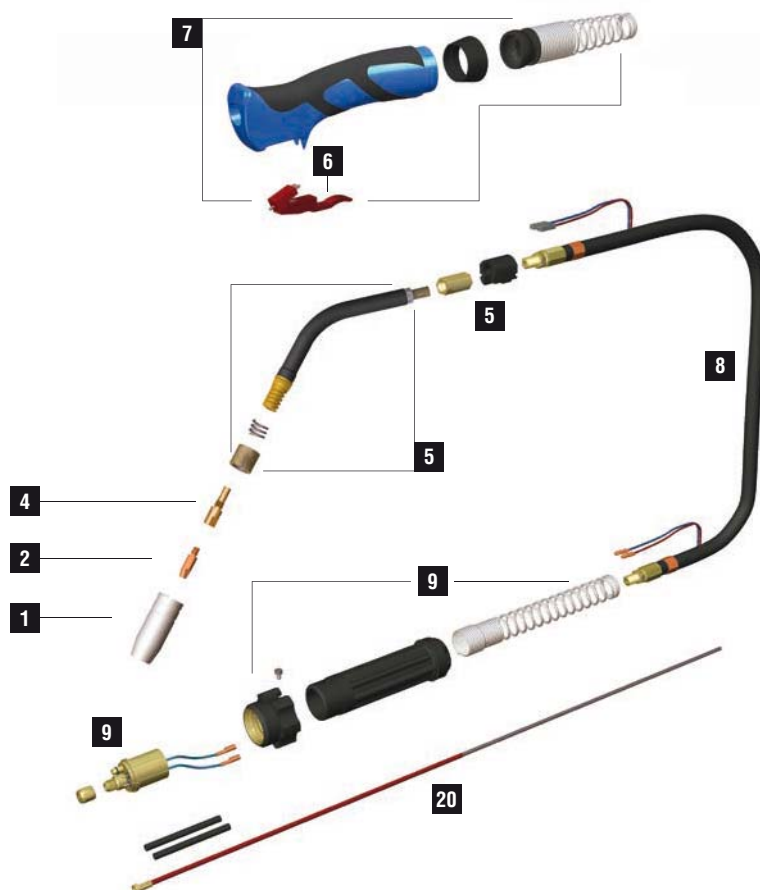

	CODE			Ø		REF	
1	MC0022			11,5 mm		57 mm	145.0124 10
1	MC0023			15 mm		57 mm	145.0076 10
1	MC0024			18 mm		57 mm	145.0042 10
1	MC0025			20 mm		66,5 mm	145.0169 10
1	MC0265			11 mm		57 mm	- 10
1	MC0267			14 mm		57 mm	- 10
2	MD0009-06		M6 - Cu	0,6 mm	.023"	28 mm	140.0005 20
2	MD0009-08		M6 - Cu	0,8 mm	.030"	28 mm	140.0051 20
2	MD0009-09		M6 - Cu	0,9 mm	.035"	28 mm	140.0169 20
2	MD0009-10		M6 - Cu	1,0 mm	.040"	28 mm	140.0242 20
2	MD0009-12		M6 - Cu	1,2 mm	.045"	28 mm	140.0379 20
2	MD0009-14		M6 - Cu	1,4 mm	.052"	28 mm	- 20
2	MD0009-16		M6 - Cu	1,6 mm	1/16"	28 mm	140.0555 20
4	ME0016		M6 - opper			35 mm	142.0001 10
4	ME0060		M6 - copper			37 mm	- 10
4	ME0216		M6 - brass			35 mm	- 10
20	GM0510		red steel liner	1,0 ÷ 1,2 mm	.040" ÷ .045"	3 m	10' 124.0026 1
20	GM0511		red steel liner	1,0 ÷ 1,2 mm	.040" ÷ .045"	4 m	12' 124.0031 1
20	GM0512		red steel liner	1,0 ÷ 1,2 mm	.040" ÷ .045"	5 m	16.4' 124.0035 1

	CODE				CODE			
5	BW0080		10		8	MH0119		3 m - 10' - 25 mm ²
5	BW0386		10		8	MH0124		4 m - 12' - 25 mm ²
5	EA0304				8	MH0125		5 m - 16.4' - 25 mm ²
5	FB0112		10		9	AR0070		EURO connection 1
5	MF0133		1	mig torch head	9	BW0020		Euro nut metal
6	BX0024		10	trigger	9	FA0026		liner nut M10X1 10
7	MT0237		1		9	MT0229		Back box kit euro 1

STANDARD

FOR ALL CONSUMABLES SEE PAGE 294