

# ERGOCUT S 35K



CE EN60974-7







CODE	↔	⚡
------	---	---

PAS104M-095-BB3	4 m	12.5'	 2 WIRES
-----------------	-----	-------	--

PAS104M-096-BB3	4 m	12.5'	 4 WIRES
-----------------	-----	-------	--

TECHNICAL DATA		
----------------	--	--

 <b>NO HF</b>		
	0,4 kg	0,88 lb
<b>V PEAK</b>	500	
	2.5 bar	
	60 l/min	
<b>X 35%</b>	32A	
	6÷8 mm	

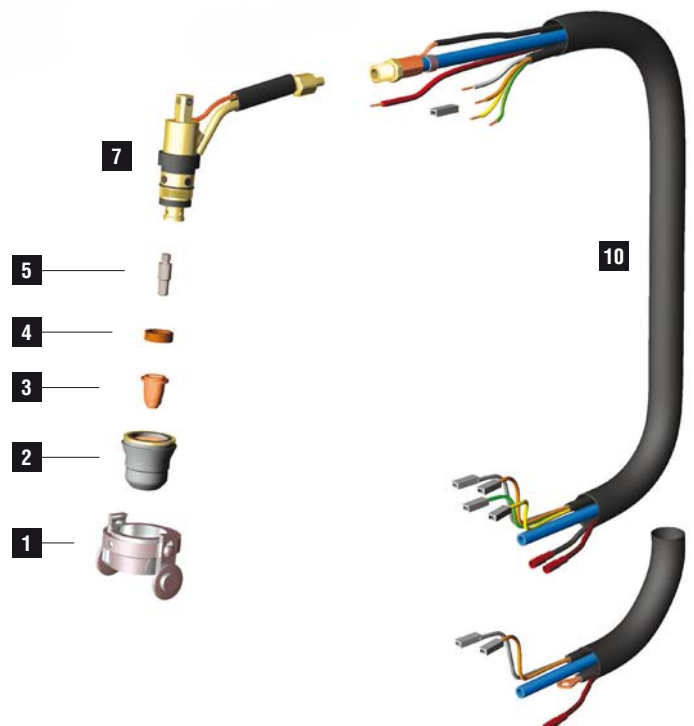
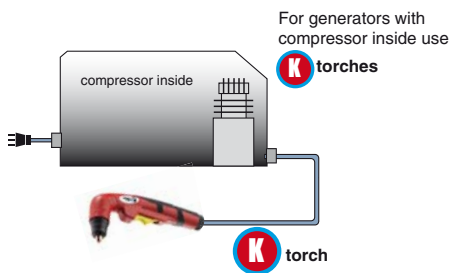

	CODE		Description	Ø	↔	CONTACT		DRAG		GOUGING	REF	
1	CV0024		plasma stand off guide	23,5 mm	33 mm							1
2	PC0135		2 rings		28 mm							4
3	PD0103-09		40 A	0,9 mm	.035"	25,8 mm					-	10
3	PD0103-65		20 A	0,65 mm	.025"	25,8 mm					-	10
3	PD0116-06		20 A	0,6 mm	.023"	17,3 mm					-	10
3	PD0116-08		30 A	0,8 mm	.030"	17,3 mm					-	10
3	PD0116-09		40 A	0,9 mm	.035"	17,3 mm					-	10
4	PE0106		plasma diffuser								-	2
5	PR0106		plasma electrode		30,5 mm							10
5	PR0110		plasma electrode		21,8 mm							10

	CODE	
7	EA0330	
7	PF0127	plasma torch head
8	TP0400	kit trigger
9	TP0401	handle kit

	CODE	
10	PH4115	4 m - direct 4 wires
10	PH4116	4 m - direct 2 wires
10	QB0044	cover (mt)

STANDARD

CONTACT SHORT CONTACT LONG DRAG SHORT DRAG LONG