

# ERGOCUT S 25



CE EN60974-7



CODE	↔	
------	---	--

PAS204M-095-BB3	4 m	12.5'	
-----------------	-----	-------	--

TECHNICAL DATA		
----------------	--	--

NO HF		
1 m	0,4 kg	0,88 lb
V PEAK	500	
5 bar		
95 l/min		
X 60%	25A	
6÷8 mm		

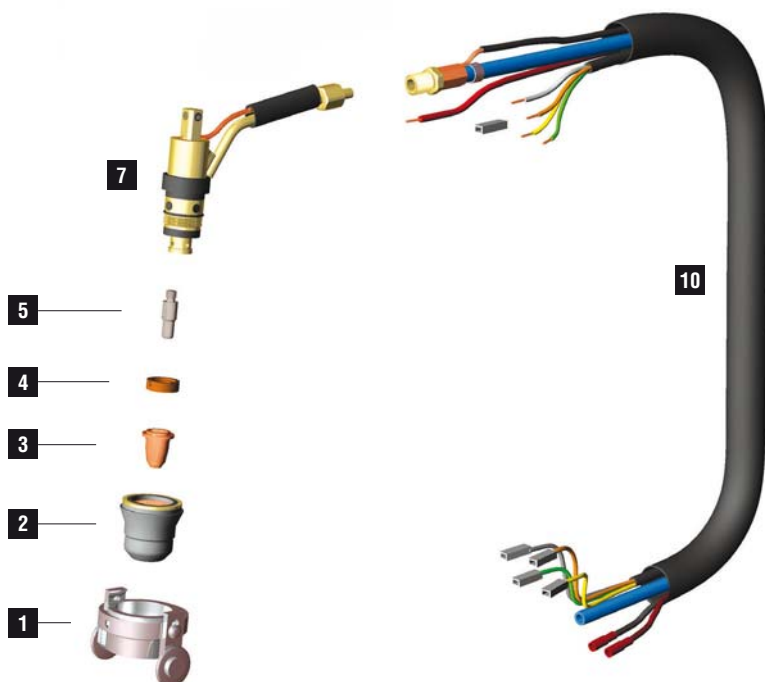
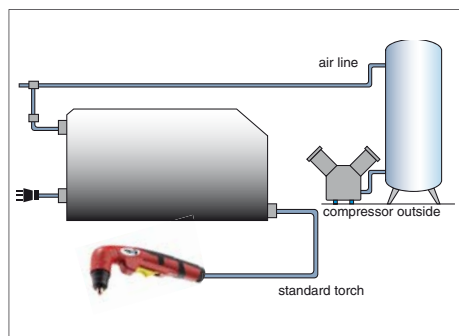

	CODE		Ø	↔	CONTACT		DRAG		GOUGING	REF			
1	CV0024		plasma stand off guide	23,5 mm	33 mm						1		
2	PC0116		no ring		28 mm						4		
3	PD0103-09		40 A	0,9 mm	.035"	25,8 mm					-	10	
3	PD0103-65		20 A	0,65 mm	.025"	25,8 mm						-	10
3	PD0116-06		20 A	0,6 mm	.023"	17,3 mm						-	10
3	PD0116-08		30 A	0,8 mm	.030"	17,3 mm						-	10
3	PD0116-09		40 A	0,9 mm	.035"	17,3 mm						-	10
4	PE0106		plasma diffuser									-	2
5	PR0106		plasma electrode		30,5 mm							10	
5	PR0110		plasma electrode		21,8 mm							10	

CODE	
------	--

7	EA0330			10
7	PF0127		plasma torch head	1
8	TP0400		kit trigger	1

CODE	
------	--

9	TP0401		handle kit	1
10	PH4116		4 m - direct 2 wires	1
10	QB0044		cover (mt)	100

STANDARD

CONTACT SHORT

CONTACT LONG

DRAG SHORT

DRAG LONG