

26 TOP







CE EN60974-7

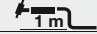

CODE	↔	⚡	⚡
------	---	---	---

HK6409-10	4 m	12.5'	lamelle	 TSK 50-M12x1
HK6809-10	8 m	25'	lamelle	
HL6409-10	4 m	12.5'	lamelle flex	
HL6809-10	8 m	25'	lamelle flex	

TECHNICAL DATA	
----------------	--

	
 1 m	0,55 kg 1.22 lb
 V PEAK	113
	Argon
 Ø	0,5 ÷ 4,0 mm .020" ÷ 5/32"
 X 35%	180A DC - 150A AC

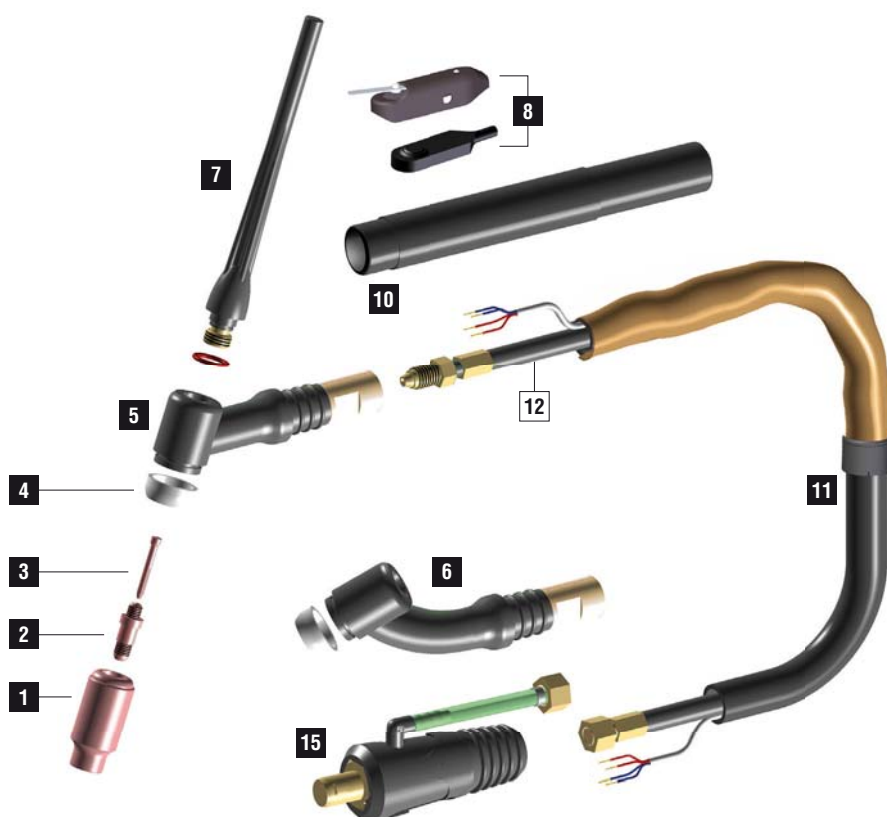

	CODE		Gr	Ø		↔	REF	
1	TC0002		4	6,4 mm	1/4"		47 mm	10N50 10
1	TC0003		5	8 mm	5/16"		47 mm	10N49 10
1	TC0004		6	9,8 mm	3/8"		47 mm	10N48 10
1	TC0005		7	11,2 mm	7/16"		47 mm	10N47 10
1	TC0006		8	12,7 mm	1/2"		47 mm	10N46 10
1	TC0007		10	15,7 mm	5/8"		47 mm	10N45 10
1	TC0008		12	19 mm	3/4"		30 mm	10N44 10
1	TC0091		5	8 mm	5/16"		76 mm	10N49L 10
1	TC0092		6	9,5 mm	3/8"		76 mm	10N48L 10
1	TC0093		7	11 mm			76 mm	10N47L 10
2	TE0001-05			0,5 mm	.020"		47 mm	10N29 10
2	TE0001-10			1,0 mm	.040"		47 mm	10N30 10
2	TE0001-16			1,6 mm	1/16"		47 mm	10N31 10
2	TE0001-20			2,0 mm	5/64"		47 mm	- 10
2	TE0001-24			2,4 mm	3/32"		47 mm	10N32 10
2	TE0001-32			3,2 mm	1/8"		47 mm	10N28 10
2	TE0001-40			4,0 mm	5/32"		47 mm	406488 10
2	TE0001-48			4,8 mm	3/16"		47 mm	30126 10
3	TD0001-05			0,5 mm	.020"		50 mm	10N21 10
3	TD0001-10			1,0 mm	.040"		50 mm	10N22 10
3	TD0001-16			1,0 mm	.040"		50 mm	10N23 10
3	TD0001-20			1,6 mm	1/16"		50 mm	- 10
3	TD0001-24			2,4 mm	3/32"		50 mm	10N24 10
3	TD0001-32			3,2 mm	1/8"		50 mm	10N25 10
3	TD0001-40			4,0 mm	5/32"		50 mm	54N20 10
3	TD0001-48			4,8 mm	3/16"		50 mm	30028 10
7	BW0056						58 mm	- 10
7	BW0066						117 mm	57Y02 10
7	BW0067						22,5 mm	57Y04 10
7	EA0130							10

	CODE			
4	TQ0002		insulator	10
5	TF0026		tig torch head	1
6	TF0027		tig torch head Flex	1
8	TT0176		gachette à lamelle	1
10	TP0005		tig handle	1
15	CX0079		tig plug 50 - gas M12x1	1

	CODE	CABLE	
11	TH1356	4 m / 12.5'	1
11	TH1357	8 m / 25'	1
	CODE	↔	
12	TH0344	4 m / 12.5'	
12	TH0345	8 m / 25'	

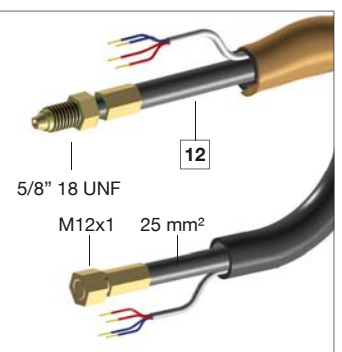

FOR ALL CONSUMABLES SEE PAGE 469