

**TURBOPLUS  
TR 480A**



CE EN60974-7



CODE	↔	
------	---	--

MB0921	4,3 m	12'	EURO
MB0922	5,3 m	16.4'	

TECHNICAL DATA		
----------------	--	--

	1.50 kg	
	1,2 ÷ 1,6 mm	.045" ÷ .1/16"
	480A CO2 - 420A Mix	
	125 m³/h	
	1350 mm/H2O	

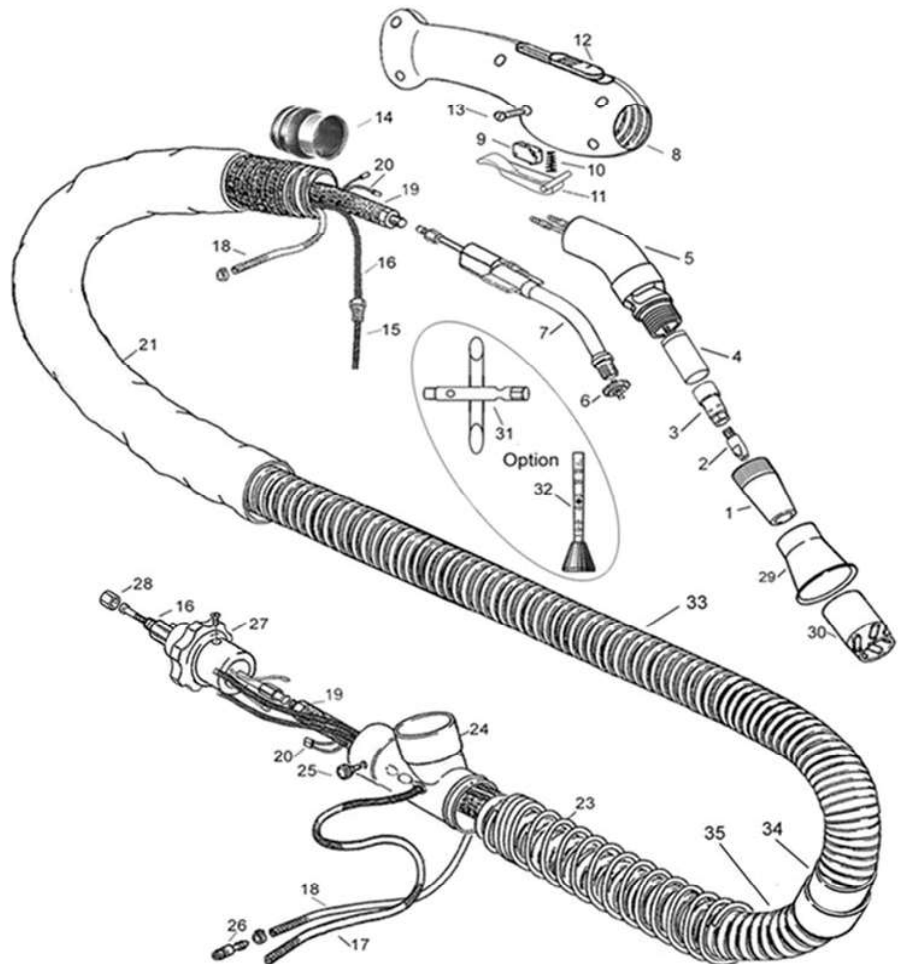

**EXTERNAL PROTECTION**  
Leather and velcro, Ø 40 mm

(OPTION)

MQ0397 . 2,5 m  
MQ0398 . 3,5 m  
MQ0399 . 4,5 m

Ideal for protecting fume extraction tubes against spatter, heat and wear.

**COOLING LIQUID**  
UTI000158

	CODE					REF			
1	MC0193		Ø 16 mm	16 mm	48 mm		1		
2	MD0005-12		M8 - Cu	1,2 mm	.045"	30 mm	140.0442	20	
2	MD0005-16		M8 - Cu	1,6 mm	1/16"	30 mm	140.0587	20	
2	MD0005-82		M8 - CuCrZr	1,2 mm	.045"	30 mm	140.0445	20	
2	MD0005-86		M8 - CuCrZr	1,6 mm	1/16"	30 mm	140.0590	20	
3	ME0442		Diffuser M8			30 mm		1	
15	GM0510		red steel liner	1,0 ÷ 1,2 mm	.040" ÷ .045"	3 m	10'	124.0026	1
15	GM0511		red steel liner	1,0 ÷ 1,2 mm	.040" ÷ .045"	4 m	12'	124.0031	1
15	GM0512		red steel liner	1,0 ÷ 1,2 mm	.040" ÷ .045"	5 m	16.4'	124.0035	1
15	GM0540		yellow steel liner	1,2 ÷ 1,6 mm	.045" ÷ 1/16"	3 m	10'	124.0041	1
15	GM0541		yellow steel liner	1,2 ÷ 1,6 mm	.045" ÷ 1/16"	4 m	12'	124.0042	1
15	GM0542		yellow steel liner	1,2 ÷ 1,6 mm	.045" ÷ 1/16"	5 m	16.4'	124.0044	1
15	GM0736		black Nylon® + 12% Graphite liner	1,2 ÷ 1,6 mm	.045" ÷ 1/16"	3 m	10'		1
15	GM0737		black Nylon® + 12% Graphite liner	1,2 ÷ 1,6 mm	.045" ÷ 1/16"	4 m	12'		1
15	GM0738		black Nylon® + 12% Graphite liner	1,2 ÷ 1,6 mm	.045" ÷ 1/16"	5 m	16.4'		1

	CODE		
4	MQ0355	Cylindric Insulator L.33	1
5	MG0244	mig torch head 50° Ø32	1
6	MQ0356	Insulator D.19	1
7	MG0243	mig torch head	1
8	MP0211	handle	1
9	BX0021	trigger	5
10	EA1270	Spiral spring	1
11	BW0593	Lever for microswitches	1
12	BW0592	Cursor control apiration	1
13	EA1271	Handle screws (6 pcs.)	1
14	FB0690	Metal turning connection for hose D.40	1
16	MH0517	Guide liner hose 3 m	1
16	MH0518	Guide liner hose 4 m	1
16	MH0519	Guide liner hose 5 m	1
17	MQ0199	Water outlet hose 0.6 m	1
18	QB0014	Water inlet hose 4 m	1
18	QB0117	Water inlet hose 3 m	1
18	QB0118	Water inlet hose 5 m	1
19	MH0203	Current/water cable 3 m - 10'	1
19	MH0204	Current/water cable 4 m - 12'	1

	CODE		
19	MH0205	Current/water cable 5 m - 16.4'	1
20	BX1042	Control Lead 3m with connectors	1
20	BX1043	Control Lead 4m with connectors	1
20	BX1044	Control Lead 5m with connectors	1
21	MQ0396	Leather and velcro hose cover 1,2 m	1
23	EA1380	Hose support spring	1
24	BW0498	Smoke deviating connection D.50 H2O	1
25	EA1275	Fixing screw for smoke deviating connection	1
26	FA3020	water - Ø 6 mm	10
27	AR0233	EURO connection	1
28	FA0026	Nut stops internal liner	1
29	FB0182	Short cilindric suction device D.32 (INCLUDED)	1
30	FB0707	Cylindric suction device D.32 (OPTION)	1
31	EA1274	Scraper gas nozzle (OPTION)	1
32	EA1273	Argon-CO2 gas flow checker (OPTION)	1
33	MQ0190	Smoke hose 3.5 m D.40 Soft	1
33	MQ0307	Smoke hose 2.5 m D.40 Soft	1
33	MQ0308	Smoke hose 4.5 m D.40 Soft	1
34	FA0062	Intermediate fitting D.50/40	1
35	MQ0135	Smoke hose 0.3 m D.50 Soft	1

STANDARD