

TURBOPLUS 480R AUT



CE EN60974-7

CODE	↔	
------	---	--

MB2930	1,8 m	 EURO
MB2931	2,8 m	
MB2932	3,8 m	
MB2933	4,8 m	

TECHNICAL DATA		
----------------	--	--

	1,40 kg	
	1,2 ÷ 1,6 mm	.045" ÷ .1/16"
	420A CO2 - 380A Mix	
	132 m³/h	
	1328 mm/H2O	

EXTERNAL PROTECTION
Leather and velcro, Ø 40 mm

(OPTION)

MQ0397 . 2,5 m
MQ0398 . 3,5 m
MQ0399 . 4,5 m

Ideal for protecting fume extraction tubes against spatter, heat and wear.

COOLING LIQUID
UTI000158

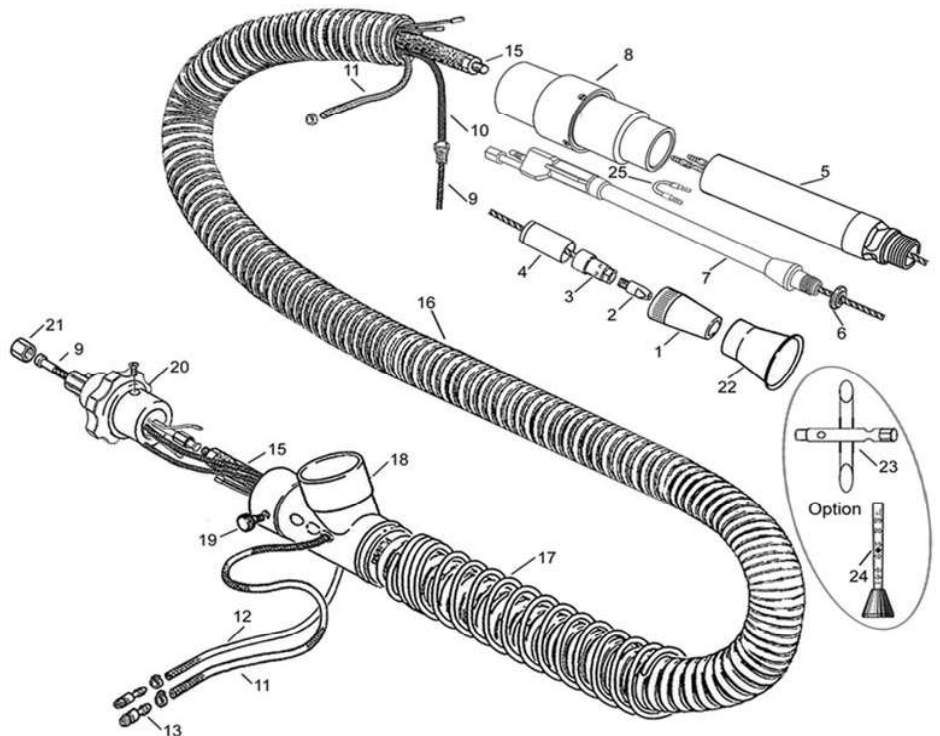

	CODE				REF				
1	MC0193		Ø 16 mm	16 mm	48 mm	1			
2	MD0005-12		M8 - Cu	1,2 mm	.045"	30 mm	140.0442	20	
2	MD0005-16		M8 - Cu	1,6 mm	1/16"	30 mm	140.0587	20	
2	MD0005-82		M8 - CuCrZr	1,2 mm	.045"	30 mm	140.0445	20	
2	MD0005-86		M8 - CuCrZr	1,6 mm	1/16"	30 mm	140.0590	20	
3	ME0442		Diffuser M8			30 mm		1	
9	GM0510		red steel liner	1,0 ÷ 1,2 mm	.040" ÷ .045"	3 m	10'	124.0026	1
9	GM0540		yellow steel liner	1,2 ÷ 1,6 mm	.045" ÷ 1/16"	3 m	10'	124.0041	1
9	GM0576		black steel liner	1,6 ÷ 2,4 mm		5 m	16.4'		1
9	GM0736		black Nylon® + 12% Graphite liner	1,2 ÷ 1,6 mm	.045" ÷ 1/16"	3 m	10'		1
9	GM0737		black Nylon® + 12% Graphite liner	1,2 ÷ 1,6 mm	.045" ÷ 1/16"	4 m	12'		1

	CODE				CODE				
4	MQ0355	cylindrical insulator L.33		1	15	MH0682		Current/water cable 2,5 m	1
5	FB0697	Threaded suction head cooling 180° D.32		1	15	MH0683		Current/water cable 3,5 m	1
6	MQ0356	Insulating washer D.19		1	15	MH0684		Current/water cable 4,5 m	1
7	MG0253	mig torch head		1	16	MQ0380		Smoke hose 1.3 m D.50	1
8	MP0172	handle		1	16	MQ0381		Smoke hose 2.3 m D.50	1
10	MH0572	Guide liner hose 1,58 m		1	16	MQ0382		Smoke hose 3.3 m D.50	1
10	MH0573	Guide liner hose 2,58 m		1	16	MQ0383		Smoke hose 4.3 m D.50	1
10	MH0574	Guide liner hose 3,58 m		1	17	EA1380		Hose support spring	1
10	MH0575	Guide liner hose 4,58 m		1	18	BW0498		Smoke deviating connection D.50 H2O	1
11	QB0145	Water inlet hose 1.6 m		1	19	EA1275		Fixing screw for smoke deviating connection	1
11	QB0146	Water inlet hose 2.6 m		1	21	FA0026		Nut stops internal liner	1
11	QB0147	Water inlet hose 3.6 m		1	22	FB0182		Short cilindric suction device D.32 (INCLUDED)	1
11	QB0148	Water inlet hose 4.6 m		1	23	EA1274		Scraper gas nozzle (OPTION)	1
12	MQ0199	Water outlet hose 0.6 m		1	24	EA1273		Argon-CO2 gas flow checker (OPTION)	1
13	FA3020	water - Ø 6 mm		10	25	FA5166		water hose joint	1
15	MH0681	Current/water cable 1,5 m		1	28	AR0232		EURO connection	1

STANDARD