



TMAX 300HD

CE EN60974-7



CODE	↔		 EURO - TW
MA6275	3 m	10'	
MA6276	4 m	12'	
MA6277	4,6 m	15'	



CODE	↔		 5/8-18 UNF
MA6270	3 m	10'	
MA6271	4 m	12'	
MA6272	4,6 m	15'	

+

CODE	
AR0170	Tweco® 1-4 kit
AR0171	Tweco® 5 kit
AR0172	Lincoln® "L" kit
AR0173	Miller® "M" kit

CODE	
AR0176	Lincoln® "L4" kit
AR0177	Lincoln® "L2" kit
AR0178	Lincoln® "L3" kit
AR0179	Lincoln® "L1" kit

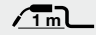
KIT to be assembled by a qualified technician.
See all details on page 264.

TECHNICAL DATA		
TMAX 300HD		
		
	0,9 kg	1.98 lb
V PEAK	113	
	0,8 ÷ 1,2 mm	.030" ÷ 0,45"
X 60%	300A CO2 - 250A Mix	

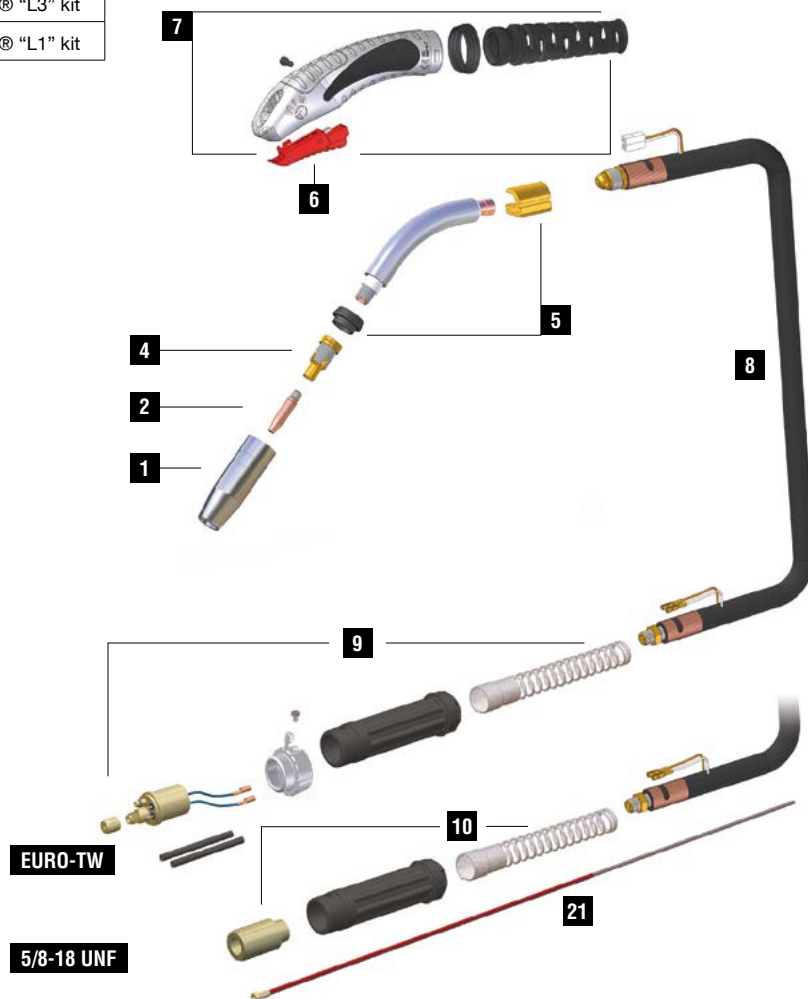

	CODE			Ø		↔	REF		
1	MC0008		nozzle	11 mm	7/16"	71 mm	2-51/64"	-	5
1	MC0009		nozzle	14 mm	9/16"	71 mm	2-51/64"	-	5
1	MC0010		nozzle	18 mm	23/32"	71 mm	2-51/64"	-	5
1	MC0128		nozzle	16 mm	5/8"	71 mm	2-51/64"	-	5
1	MC0129		nozzle	14 mm	9/16"	71 mm	2-51/64"	-	10
2	MD0300-08		M7x1 - Cu	0,8 mm	.030"	36 mm	1"-13/32	-	20
2	MD0300-09		M7x1 - Cu	0,9 mm	.035"	36 mm	1"-13/32	-	20
2	MD0300-10		M7x1 - Cu	1,0 mm	.040"	36 mm	1"-13/32	-	20
2	MD0300-12		M7x1 - Cu	1,2 mm	.045"	36 mm	1"-13/32	-	20
2	MD0300-14		M7x1 - Cu	1,4 mm	.052"	36 mm	1"-13/32	-	20
2	MD0300-16		M7x1 - Cu	1,6 mm	1/16"	36 mm	1"-13/32	-	20
4	ME0369		M7 - brass TMAX 300 HD			33 mm	1"-5/16	-	5
21	GM0012		red steel liner for EURO-TW connector	1,0 ÷ 1,2 mm	.040" ÷ .045"	5 m	16.4'	42-4045-15	1

	CODE			
5	FB0653		torch head holder	1
5	MF0369		Tmax 300 HD torch head	1
5	MQ0341		insulator	1
6	BX0742		trigger	1
7	MT0260		handle kit	1
8	MH0470		coaxial cable - 3 m / 10'	1
8	MH0471		coaxial cable - 4 m / 12'	1

	CODE			
8	MH0472		coaxial cable - 4,6 m / 15'	1
9	AR0083		EURO-TW connector	1
9	BW0480		EURO nut	1
9	FA0027		liner nut M11x1	10
9	MT0229		Back box kit EURO	1
10	FB0395		5/8-18 UNF power connector	1
10	MT0228		Back box kit 5/8-18 UNF	1

TMAX 300

	CODE			
4	ME0366		M7 - brass tmax 300	5

STANDARD

FOR ALL WEAR PARTS SEE PAGE 276