





ERGOPLUS 40

CE EN60974-7

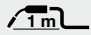

CODE	↔		
MA7584	4 m	12'	 EURO

TECHNICAL DATA		
ERGOPLUS 40		
	1,6 kg	3.53 lb
	113	
V PEAK	113	
	0,6 ÷ 1,6 mm	.023" ÷ 1/16"
X 60%	340A CO2 - 320A Mix	

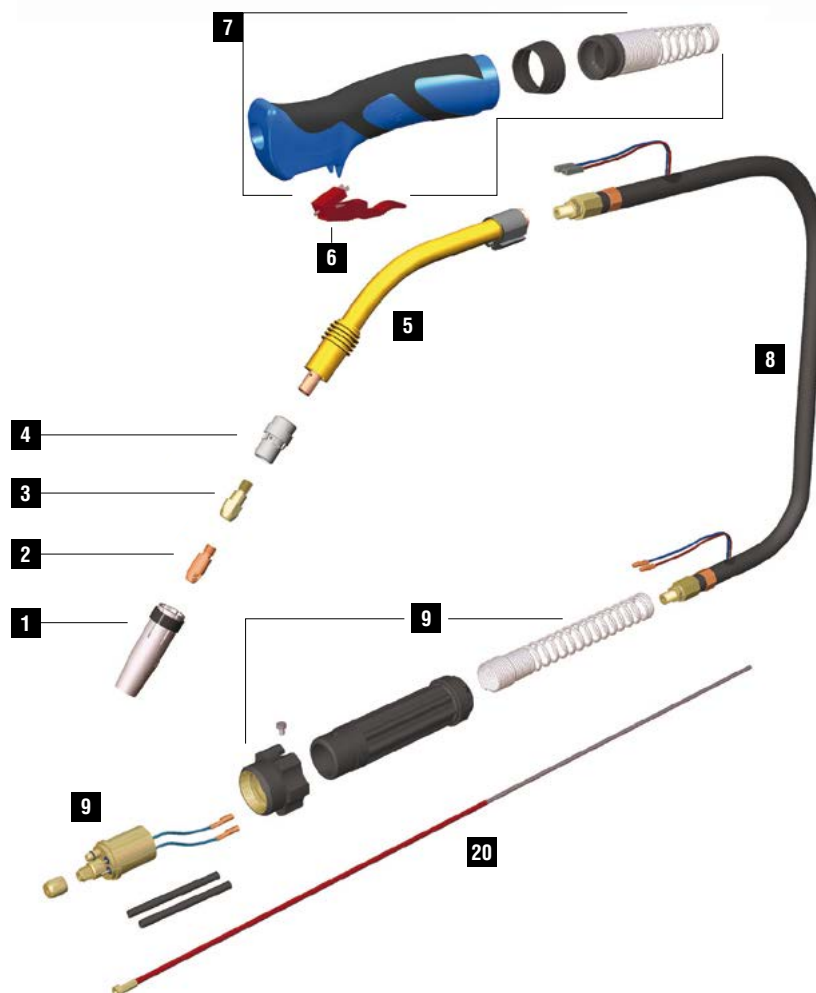

	CODE			Ø		↔		REF	
1	MC0367		nozzle	16 mm	5/8"	90 mm	3"-17/32	145.0079	10
2	MD0005-78		M8 - CuCrZr	0,8 mm	.030"	30 mm	1"-3/16	-	20
2	MD0005-80		M8 - CuCrZr	1,0 mm	.040"	30 mm	1"-3/16	140.0316	20
2	MD0005-82		M8 - CuCrZr	1,2 mm	.045"	30 mm	1"-3/16	140.0445	20
2	MD0005-84		M8 - CuCrZr	1,4 mm	.052"	30 mm	1"-3/16	140.0536	20
2	MD0005-86		M8 - CuCrZr	1,6 mm	1/16"	30 mm	1"-3/16	140.0590	20
2	MD0005-90		M8 - CuCrZr	2,0 mm	5/64"	30 mm	1"-3/16	140.0656	20
2	MD0005-94		M8 - CuCrZr	2,4 mm	3/32"	30 mm	1"-3/16	-	20
3	MD0199-00		M8 - brass			43 mm	1" 11/16	142.0021	20
4	ME0518		ceramic			35,5 mm		015.0021	10
20	GM0511		red steel liner	1,0 ÷ 1,2 mm	.040" ÷ .045"	4 m	12'	124.0031	1

	CODE			
5	MF0337		Ergoplus 40 torch head	1
6	BX0024		trigger	5
7	MT0237		handle kit	1
8	MH0127		coaxial cable - 4 m / 12'	1

	CODE			
9	AR0070		EURO connector - air	1
9	BW0020		metal EURO nut	10
9	FA0026		liner nut M10x1	10
9	MT0229		Back box kit EURO	1

STANDARD

FOR ALL WEAR PARTS SEE PAGE 276