





# ERGOPLUS 26



CE EN60974-7



CODE	↔			
MA7343	3 m	10'	 EURO	1
MA7344	4 m	12'		1
MA7345	5 m	16.4'		1

CODE	↔			
MA7394	3 m	10'	 EURO	25
MA7395	4 m	12'		25
MA7396	5 m	16.4'		25

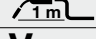
TECHNICAL DATA		
<b>ERGOPLUS 26</b>		
	1,46 kg	3.22 lb
	113	
<b>V PEAK</b>	113	
	0,8 ÷ 1,2 mm	.030" ÷ .45"
<b>X 60%</b>	290A CO2 - 260A Mix	

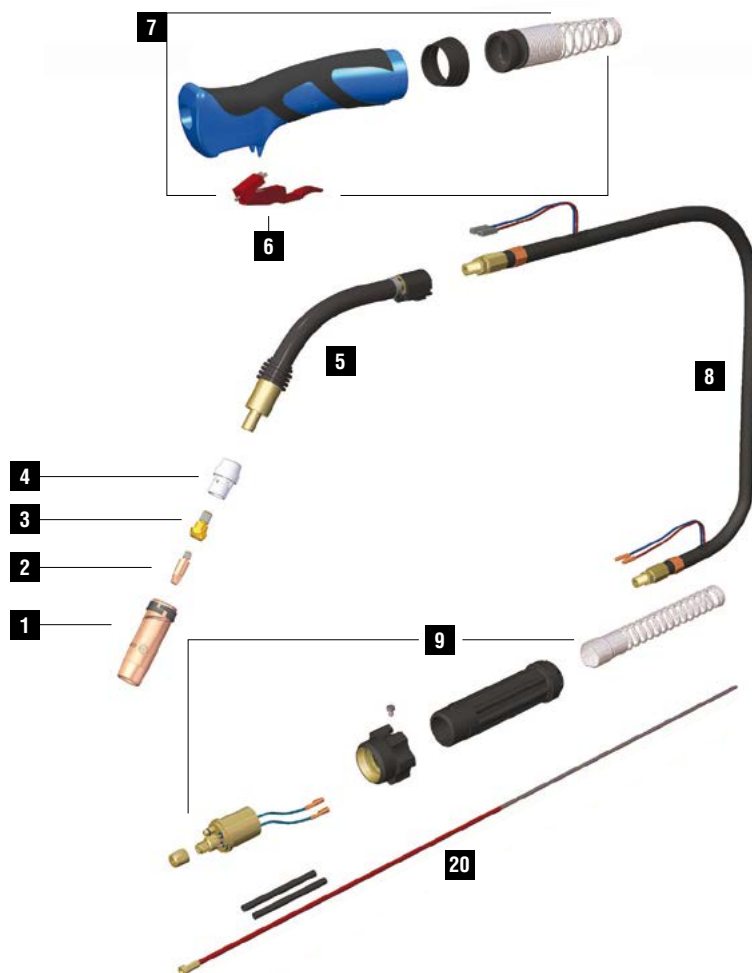

	CODE			Ø		↔		REF	
1	MC0268		nozzle - 2,5 mm thickness	16 mm	5/8"	76 mm	3"	145.0085	10
1	MC0276		nozzle - 2 mm thickness	16 mm	5/8"	76 mm	3"	145.0085	10
1	MC0290		nozzle - 2,5 mm thickness	14 mm	9/16"	76 mm	3"	145.0132	10
1	MC0291		nozzle - 2,5 mm thickness	20 mm	25/32"	76 mm	3"	145.0051	10
1	MC0292		nozzle - 2,5 mm thickness	15 mm	19/32"	76 mm	3"	-	10
1	MC0293		nozzle - 2,5 mm thickness	20 mm	25/32"	82 mm	3-7/32"	145.0179	10
1	MC0340		heavy duty nozzle - 3 mm thickness	16 mm	5/8"	76 mm	3"		10
1	MC0568		quick release nozzle - 2,5 mm thickness	16 mm	5/8"	76 mm	3"	-	10
1	MC0576		quick release light nozzle - 2 mm thickness	16 mm	5/8"	76 mm	3"	-	10
2	MD0009-06		M6 - Cu	0,6 mm	.023"	28 mm	1"-3/32	140.0005	20
2	MD0009-08		M6 - Cu	0,8 mm	.030"	28 mm	1"-3/32	140.0051	20
2	MD0009-09		M6 - Cu	0,9 mm	.035"	28 mm	1"-3/32	140.0169	20
2	MD0009-10		M6 - Cu	1,0 mm	.040"	28 mm	1"-3/32	140.0242	20
2	MD0009-12		M6 - Cu	1,2 mm	.045"	28 mm	1"-3/32	140.0379	20
2	MD0009-14		M6 - Cu	1,4 mm	.052"	28 mm	1"-3/32	-	20
2	MD0009-16		M6 - Cu	1,6 mm	1/16"	28 mm	1"-3/32	140.0555	20
3	MD0061-00		M6 - brass			22 mm	7/8"	142.0007	20
3	MD0062-00		M8 - brass			22 mm	7/8"	142.0082	20
4	ME0085		plastic			29 mm	1"-5/32	018.0116	10
4	ME0485		plastic			29 mm	1"-5/32	-	10
4	ME0585		ceramic			29 mm	1"-5/32	018.0141	10
20	GM0510		red steel liner	1,0 ÷ 1,2 mm	.040" ÷ .045"	3 m	10'	124.0026	1
20	GM0511		red steel liner	1,0 ÷ 1,2 mm	.040" ÷ .045"	4 m	12'	124.0031	1
20	GM0512		red steel liner	1,0 ÷ 1,2 mm	.040" ÷ .045"	5 m	16.4'	124.0035	1

	CODE			
5	MF0181		Ergoplus 26 torch head	1
6	BX0024		trigger	5
7	MT0237		handle kit	1
8	MH0141		coaxial cable - 3 m / 10'	1
8	MH0142		coaxial cable - 4 m / 12'	1

	CODE			
8	MH0144		coaxial cable - 5 m / 16.4'	1
9	AR0070		EURO connector - air	1
9	BW0020		metal EURO nut	10
9	FA0026		liner nut M10x1	10
9	MT0229		Back box kit EURO	1

STANDARD

FOR ALL WEAR PARTS SEE PAGE 276