

# ERGOCUT S 75

CE EN60974-7



CODE	↔		
PAS506M-000-BA3	6 m	19.7'	1/4 GAS
PAS506M-071-BA3	6 m	19.7'	3/8 GAS
PAS506M-004-BA3	6 m	19.7'	CENTRAL 004
PAS506M-304-BA3	6 m	19.7'	TRAFIMECTOR® 304

TECHNICAL DATA		
<b>NO HF</b>	<b>ERGOCUT S 75</b>	
	0,7 kg	1.54 lb
	500	
	5 bar	
	150 l/min	
	70A	
	50A	
	18-23 mm	23/32"-29/32"

For Central 004 and Trafimector 304 pin connection scheme see page 114

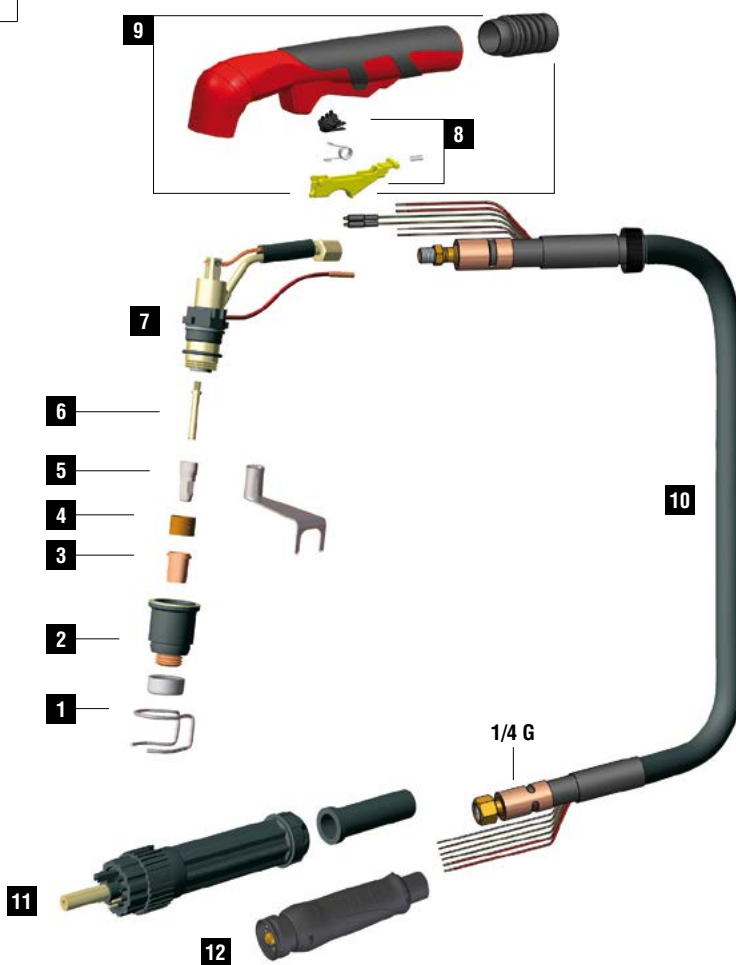
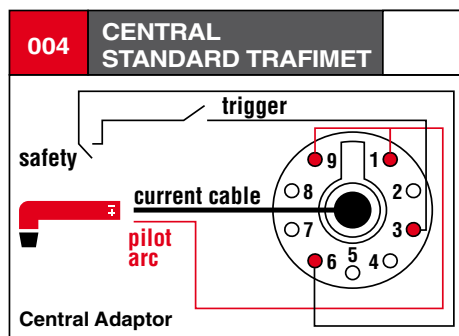

	CODE		Description	Ø	↔	CONTACT		DRAG		GOUGING	REF	
1	CV0026		stand off guide		25,5 mm							2
1	CV0028		stand off guide		20,5 mm							10
1	CV0033		stand off guide		26 mm							2
1	CV0051		stand off guide	24,3 mm	31 mm							1
2	CV0076		for PC0114		9,7 mm							10
2	PC0114		nozzle (CV0076 included)		39,5 mm							2
3	PD0114-10		50 A	1,0 mm	.040"	18,6 mm					-	10
3	PD0114-12		70 A	1,2 mm	.047"	18,6 mm					-	10
3	PD0118-10		50 A	1,0 mm	.040"	31,1 mm					-	10
4	PE0112		diffuser		11,5 mm						-	2
5	CV0080		tool for wear parts									1
5	PR0117		electrode		23,7 mm							10
5	PR0119		electrode		36,2 mm							10
6	FH0647		air tube		36 mm							10

	CODE		Description	
7	EA0223		O-ring Ø 18x1 mm	10
7	PF0135		Ergocut S 75 torch head	1
8	TP0400		trigger kit	1
9	TP0402		handle kit	1
10	PH4003		coaxial cable - 6 m / 19.7' - 1/4 G (no pin)	1
10	PH4009		coaxial cable - 6 m / 19.7' - 3/8 G (no pin)	1

	CODE		Description	
11	BW0147		cable support	10
11	FY0023		plasma central adaptor - 5 pins	1
12	FY0090		TRAFIMECTOR® central adaptor - torch side	1
	EA0254		pin extractor for central adaptor	1
	PT0202		male spring pins kit (5 pcs)	1

STANDARD

CONTACT SHORT CONTACT LONG DRAG SHORT DRAG LONG GOUGING