







ERGOCUT S 25

CE EN60974-7

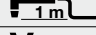

CODE	↔		
PAS204M-095-BB3	4 m	12.5'	 DIRECT 2 WIRES

TECHNICAL DATA		
 NO HF	ERGOCUT S 25	
 1m	0,4 kg	0.88 lb
V PEAK	500	
	5 bar	
	95 l/min	
X 60%	25A	
	6-8 mm	1/4"-5/16"

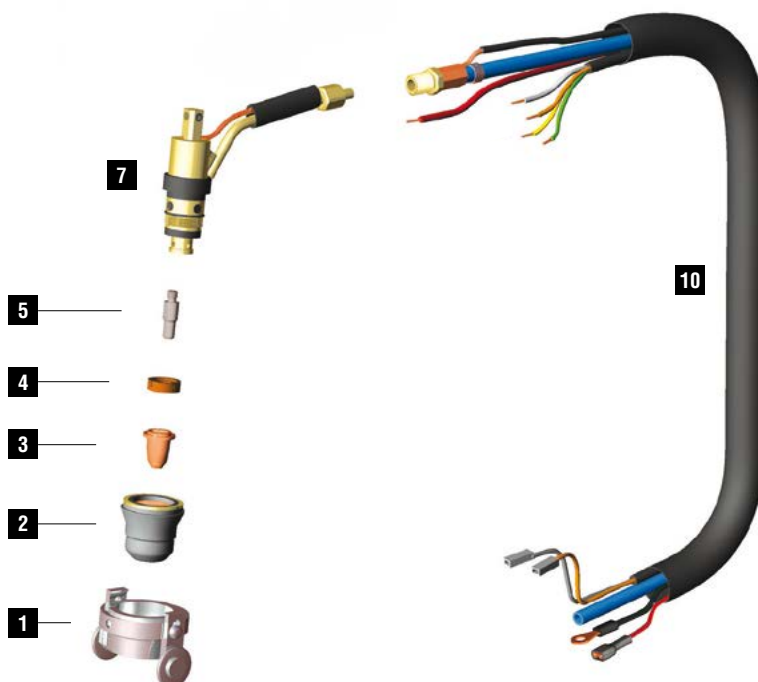
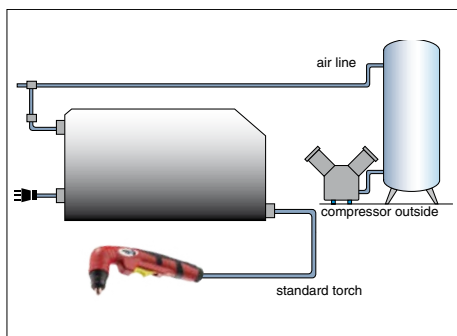

	CODE		description	Ø		↔		CONTACT		DRAG		GOUGING	REF		
1	CV0024		stand off guide	23,5 mm		33 mm									1
2	PC0116		nozzle (no ring)			28 mm							60389		4
3	PD0103-09		40 A	0,9 mm	.035"	25,8 mm							-		10
3	PD0103-65		20 A	0,65 mm	.025"	25,8 mm							-		10
3	PD0116-06		20 A	0,6 mm	.023"	17,3 mm							-		10
3	PD0116-08		30 A	0,8 mm	.030"	17,3 mm							-		10
3	PD0116-09		40 A	0,9 mm	.035"	17,3 mm							-		10
4	PE0106		Swirl ring			4,6 mm							60028		2
5	PR0106		electrode			30,5 mm									10
5	PR0110		electrode			21,8 mm									10

	CODE		description	
7	EA0330		o-ring	10
7	PF0127		Ergocut S25K-S35K-S25-S45	1
8	TP0400		trigger kit	1

	CODE		description	
9	TP0401		handle kit	1
10	PH4016		cable assembly - 4 m / 12' - direct 2 wires	1

STANDARD

CONTACT SHORT CONTACT LONG DRAG SHORT DRAG LONG GOUGING